

**CITY OF FREEPORT  
PLANNING COMMISSION  
Tuesday, March 24, 2009, 6:00 p.m.  
Freeport Police Department, Municipal Court Room  
430 North Brazosport Boulevard  
Freeport, Texas**

**AGENDA**

Diane Williams, Chairperson  
Alonzo Martinez  
Joyce Adkins

Eric Hayes  
Roberto Caceres  
Rueben Cuellar

NOTICE is hereby given that the Planning Commission of the City of Freeport, Texas will meet in a regularly scheduled meeting on **Tuesday, March 24, 2009 at 6:00 P.M.** at the Freeport Police Department Municipal Courtroom, 430 North Brazosport Boulevard, Freeport, Texas to discuss the following:

1. Open Meeting.
2. Invocation.
3. Approval of minutes for February 24, 2009.
4. Discussion on the need to place stop signs at Yellowstone and O and along Yaupon.
5. Review existing truck ordinances and routes.
  - a. Identify possible changes, if any
  - b. Examine truck route signage and update.
  - c. Presentation of proposed 18-wheeler truck routes by Commission Members.
6. Adjourn.

**NOTE: ITEMS NOT NECESSARILY DISCUSSED IN THE ORDER THEY APPEAR ON THE AGENDA. THE PLANNING COMMISSION, AT ITS DISCRETION, MAY TAKE ACTION ON ANY OR ALL OF THE ITEMS LISTED.**

I, Melissa Farmer, Building/Permit Department Secretary, City of Freeport, Texas, hereby certify that this Agenda was posted on the official bulletin board/glass door of City Hall facing the rear parking lot of the building with 24-hour access at 200 West 2<sup>nd</sup> Street, Freeport, Texas on or before Friday, March 20, 2009 at 5:00 P.M.

---

Melissa Farmer  
Building/Permit Department  
City of Freeport

STATE OF TEXAS        )(

COUNTY OF BRAZORIA   )(

CITY OF FREEPORT     )(

BE IT REMEMBERED that the Planning and Traffic Commission of the City of Freeport, Texas met in a regular meeting on **Tuesday, February 24, 2009 at 6:00 P.M.** at the Police Department Conference Room, 430 North Brazosport Boulevard, Freeport, Texas to discuss the following:

**Planning Commission:**

*Diane Williams, Chairperson  
Eric Hayes  
Roberto Caceres  
Reuben Cuellar  
Alonzo Martinez  
Joyce Adkins*

**Staff:**

*Larry Ellis  
Melissa Farmer  
Nat Hickey  
Wallace Shaw  
Mayor Larry McDonald  
Councilman Ron Wise*

**Visitors:**

Rosa McDonald  
Pixie Floyd

**Open Meeting.**

Ms. Diane Williams called meeting to order at 6:00 P.M.

**Invocation.**

Mr. Eric Hayes called for a moment of silence.

**Approval of Minutes.**

Mr. Eric Hayes moved to accept the minutes for January 27, 2009, seconded by Ms. Rueben Cuellar, by a vote of 5 to 1, with Ms. Joyce Adkins opposing, the minutes were approved.

**Discuss/consider recommendations to City Council regarding changes, if any, to Insurance Required under Section 150.091 (A) and 150.106 (A) of the Code of Ordinances book.**

Mr. Larry Ellis explained to the Planning Commission that the building secretary had spoken to the Texas Department of Insurance and that she was told that the State of Texas did not require business owners to carry Workers Compensation Insurance. He told them that small business owners would not be able to afford the insurance that the City required and that most business owners would not be able to work in Freeport if they were required to carry this insurance.

Ms. Joyce Adkins made a motion to send Ordinance 150.091 (A) and 150.106 (A) to the City Council to be eliminated from the Code of Ordinance book, seconded by Mr. Alonzo Martinez, by a vote of 5 to 1, with Mr. Roberto Caceres voting against, the motion passed.

**Adjourn.**

Mr. Eric Hayes made a motion to adjourn, seconded by Mr. Alonzo Martinez. Meeting was adjourned at 6:50 P.M.

These minutes read and approved this \_\_\_\_\_ day of \_\_\_\_\_, 2009.

---

Diane Williams, Chairperson



CHAPTER 76: TRANSPORTATION OF FREIGHT AND HAZARDOUS MATERIAL

Section

- 76.01 Definitions
- 76.02 Restrictions on transportation of cargo
- 76.03 Affirmative defenses

**TRUCK TRACTOR.** A motor vehicle designed and used primarily to draw another vehicle but not constructed to carry a load other than a part of the weight of the other vehicle and its load.

**VEHICLE.** A device that can be used to transport or draw cargo on a street or highway other than a device exclusively used on stationary rails or tracks.  
(Ord. 2002-1985, passed 6-17-02)

§ 76.01 DEFINITIONS.

For the purpose of this chapter, the following definitions shall apply unless the context clearly indicates or requires a different meaning.

**BULK.** Liquid or gaseous cargo other than hazardous material.

**CARGO.** Any property capable of being transported by means of a truck or a truck tractor with trailer attached.

**FREIGHT.** Cargo other than bulk or hazardous material.

**HAZARDOUS MATERIAL.** Any cargo described as a hazardous material in the current edition of the Emergency Response Guidebook published by the U.S. Department of Transportation.

**LIGHT TRUCK.** A truck, including a pickup truck, panel delivery truck, or carryall truck, that has a manufacturer's rated carrying capacity of 2,000 pounds or less.

**MOTOR VEHICLE.** A self-propelled vehicle.

**TRAILER.** A vehicle designed to be drawn by a motor vehicle to transport property.

**TRUCK.** A motor vehicle designed, used or maintained primarily to transport property.

§ 76.02 RESTRICTIONS ON TRANSPORTATION OF CARGO.

(A) No person shall operate a truck other than a light truck, or a truck tractor with a trailer attached thereto, for the purpose of transporting bulk or freight on any public street in the city, or any portion thereof, other than a street, or portion thereof, designated in division (C) of this section for the transportation of bulk or freight.

(B) No person shall operate a truck, or a truck tractor with a trailer attached thereto, for the purpose of transporting any hazardous material on any public street in the city, or any portion thereof, other than a street, or portion thereof, designated in division (C) of this section for the transportation of hazardous material.

(C) The following streets, or indicated portions thereof, are authorized for the bi-directional transportation of bulk, freight or hazardous materials, as designated:

- (1) Highway 332, within city limits: bulk, freight or hazardous materials.

- (2) Brazosport Boulevard (State Highway 288), within city limits: bulk, freight or hazardous materials.
- (3) Navigation Boulevard (FM 1495) between the south city limits and FM 523: bulk, freight or hazardous materials.
- (4) FM 523 from Navigation Boulevard (FM 1495) junction north to Highway 332: bulk, freight or hazardous materials.
- (5) Velasco Boulevard from FM 523 junction to South Avenue A: bulk or freight only.
- (6) South Avenue A, from Archer to Division Street: bulk or freight only.
- (7) Division Street, from South Avenue A to Gulf Boulevard: bulk or freight only.
- (8) Gulf Boulevard, from Brazosport Boulevard to Navigation Boulevard (FM 1495): bulk, freight or hazardous materials.
- (9) West 4th Street, from Brazosport Boulevard to Arbutus Street: bulk or freight only.
- (10) Arbutus Street, from West 4th Street to West 2nd Street: bulk or freight only.
- (11) Oak Street, from West Brazos to West 4th Street: bulk or freight only.
- (12) West 4th Street, from Oak Street to Navigation Boulevard (FM 1495): bulk and freight only.
- (13) East 4th Street, from Navigation Boulevard (FM 1495) to Sycamore: freight and hazardous materials.
- (14) Sycamore Street, from East 4th Street to East 2nd Street: bulk, freight and hazardous materials.
- (15) East Brazos, entire length: bulk, freight and hazardous materials. Provided, all ingress and egress for fuel deliveries shall use the East 4th Street exit from Navigation Boulevard (FM 1495) to Sycamore Street to West Brazos.
- (16) West 8th Street, from Navigation Boulevard (FM 1495) to Cherry Street: bulk and freight only.
- (17) Cherry Street, from West 8th Street to Highway 36: bulk and freight only.
- (18) South Avenue D, from Velasco Boulevard to Navigation Boulevard (FM 1495): bulk and freight only.
- (19) East 2nd Street, from FM 1495 to end of roadway: bulk, freight and hazardous materials. Provided, however, all hazardous materials deliveries shall ingress and egress using the East 4th Street exit from Navigation Boulevard (F.M. 1495) to Sycamore Street to East 2nd Street.
- (20) Zapata Street, from Brazosport Boulevard to end of roadway: bulk and freight only.
- (21) Skinner Street, from Brazosport Boulevard to North Avenue J: bulk and freight only.
- (22) North Avenue J, from Skinner Street to Varner Street: bulk and freight only.
- (23) Varner Street, from North Avenue J to Brazosport Boulevard, bulk and freight only.
- (24) Victoria Street, from Brazosport Boulevard to end of roadway: bulk and freight only.
- (25) Archer Street, from South Avenue A to South Gulf Boulevard: bulk and freight only.

(26) Sailfish, from Highway 332 to end of roadway: bulk and freight only.

(27) Tarpon, from Sailfish to Marlin Avenue: bulk and freight only.

(28) Marlin Avenue, from Tarpon to the end of the roadway: bulk and freight only.

(29) Casco, from Highway 332 to end of roadway: bulk and freight only.

(D) All liquid and solid hazardous materials, including precursors, are prohibited within a one city block radius of the City Hall of the city.

(E) Box or cargo vans delivering supplies and cargo within the one block radius of the City Hall of the city are subject to a 15-minute or one-fourth hour parking rule.

(Ord. 2002-1985, passed 6-17-02) Penalty, see § 10.99

(D) Is delivering fuel to an area outside of the approved hazardous materials route designated in § 76.02(C) and the operator is ingressing or egressing such area utilizing the shortest distance between the approved route and the delivery destination.

(Ord. 2002-1985, passed 6-17-02) Penalty, see § 10.99

**§ 76.03 AFFIRMATIVE DEFENSES.**

It shall be an affirmative defense to a prosecution under § 76.02(A) if the truck or truck tractor in question is:

(A) Owned by the city or a firm or corporation having a franchise from the city to provide utility services or to collect and haul solid waste within the city;

(B) Owned by a firm or corporation having a contract to construct, reconstruct, repair or maintain the public street or portion thereof upon which such vehicle is then and there being operated;

(C) Is making a bulk or freight residential delivery from an approved route designated in § 76.02(C) and the operator is ingressing or egressing such residence utilizing the shortest distance between the approved route and the delivery destination; or

# City of Freeport Truck Route

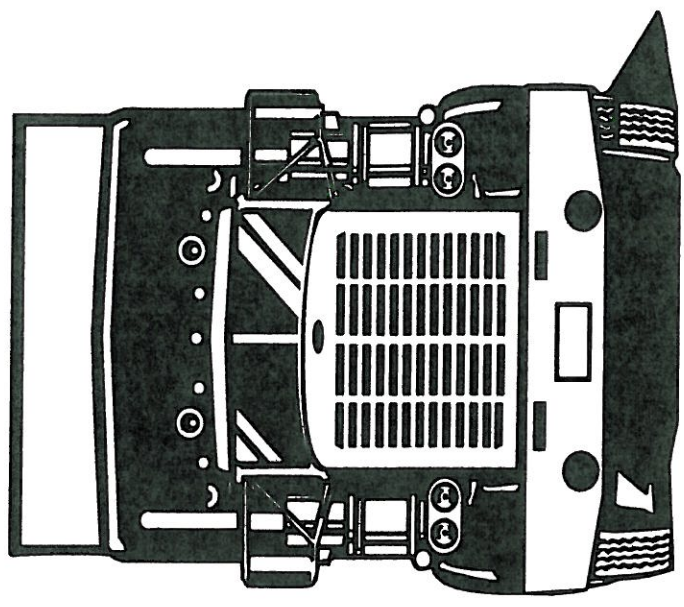

## Hwy 332

East and West bound directions from city limits to city limits shall be open bi-directionally for all tractor trailer transport, bulk and hazardous materials



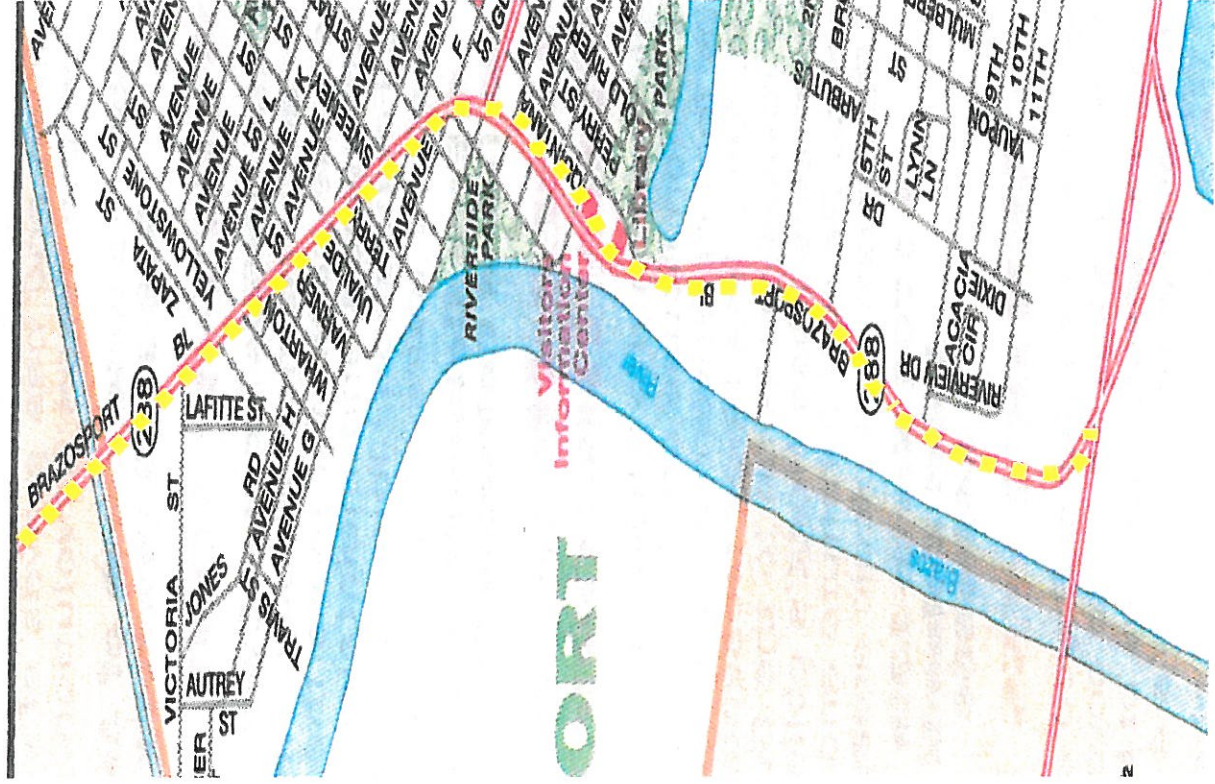

Brazosport Blvd.

Or Business 288

North and South bound directions  
north city limits to Hwy 36 shall be  
open bi-directionally for all tractor  
trailer transport, bulk, and  
hazardous materials

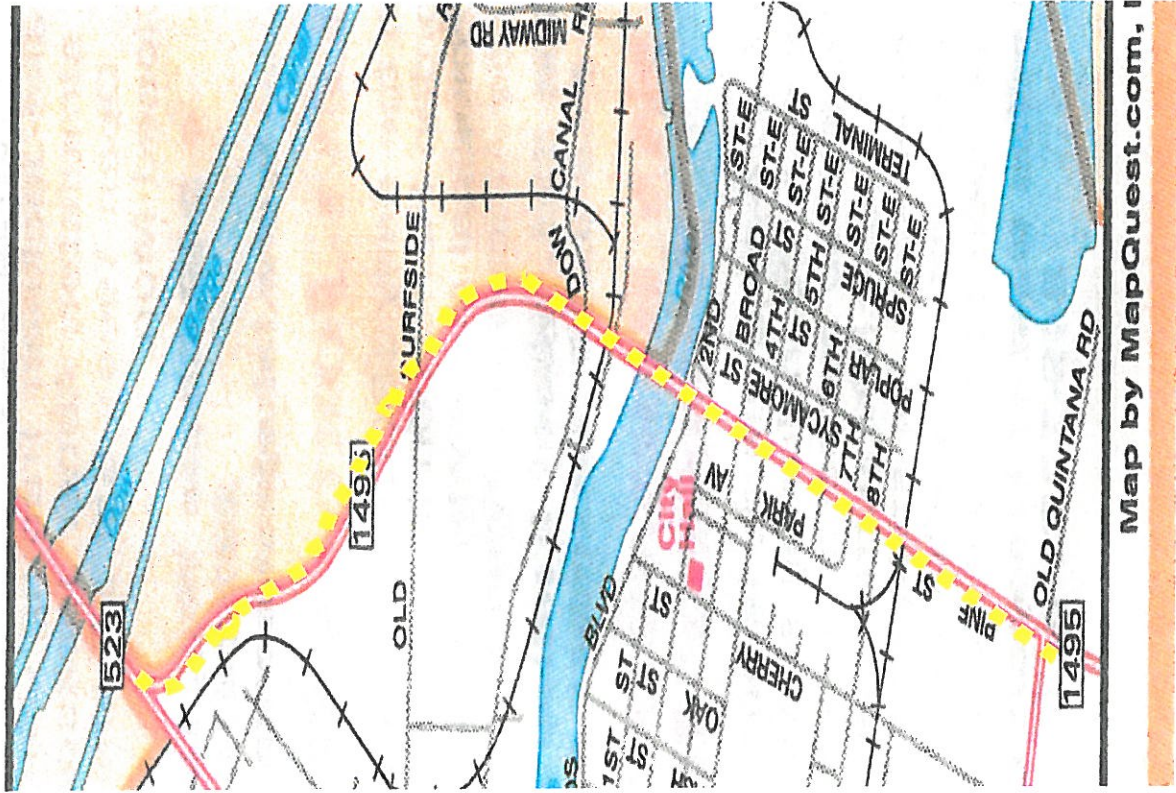

## FM 1495

Between Hwy 36 and  
FM 523 shall be open  
bi-directionally for all  
tractor trailer transport,  
bulk and hazardous  
materials



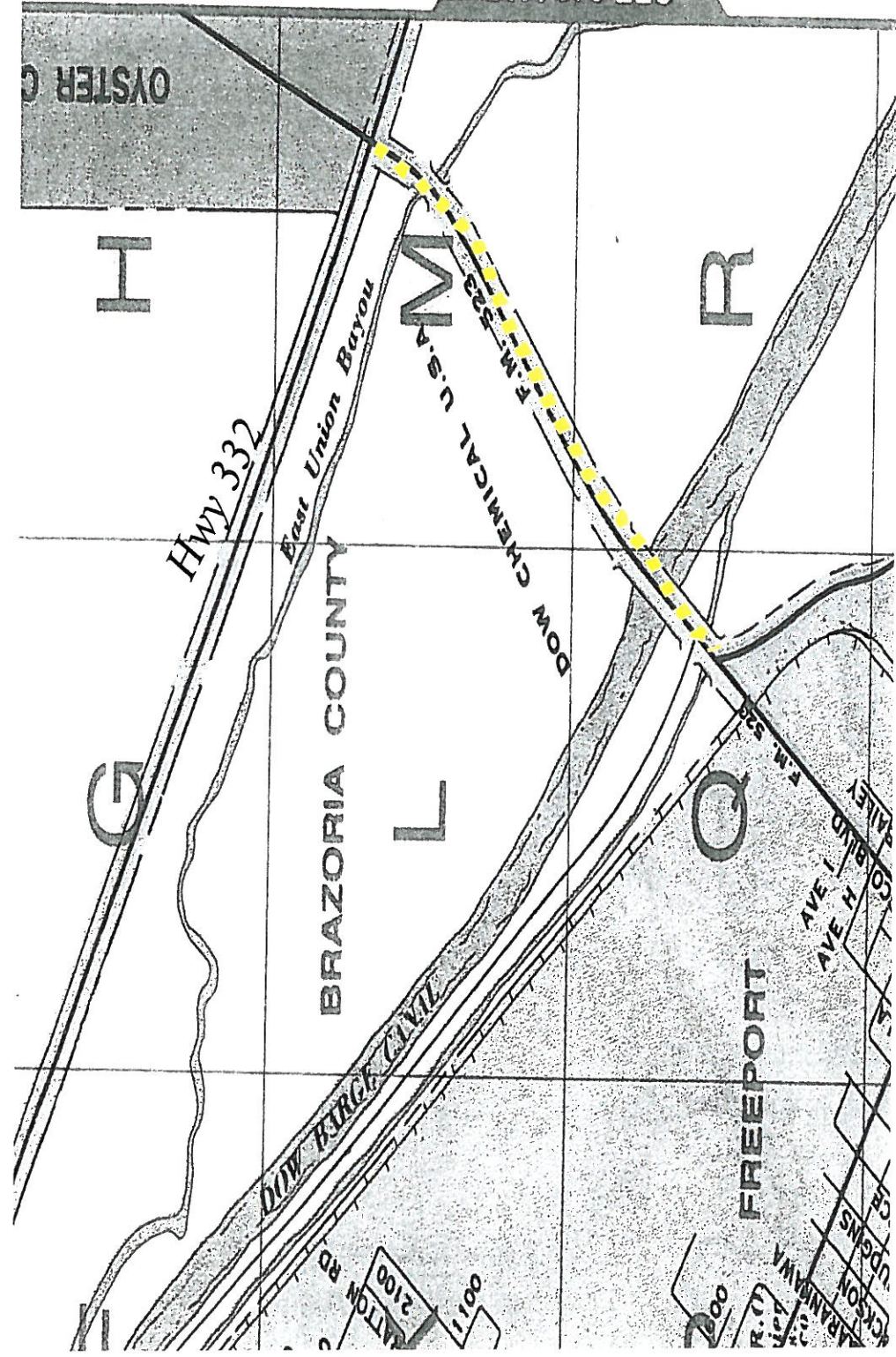

### FM 523

From FM 1495 junction North to Hwy 332 shall be open bi-directionally for tractor trailer transport, bulk and hazardous materials



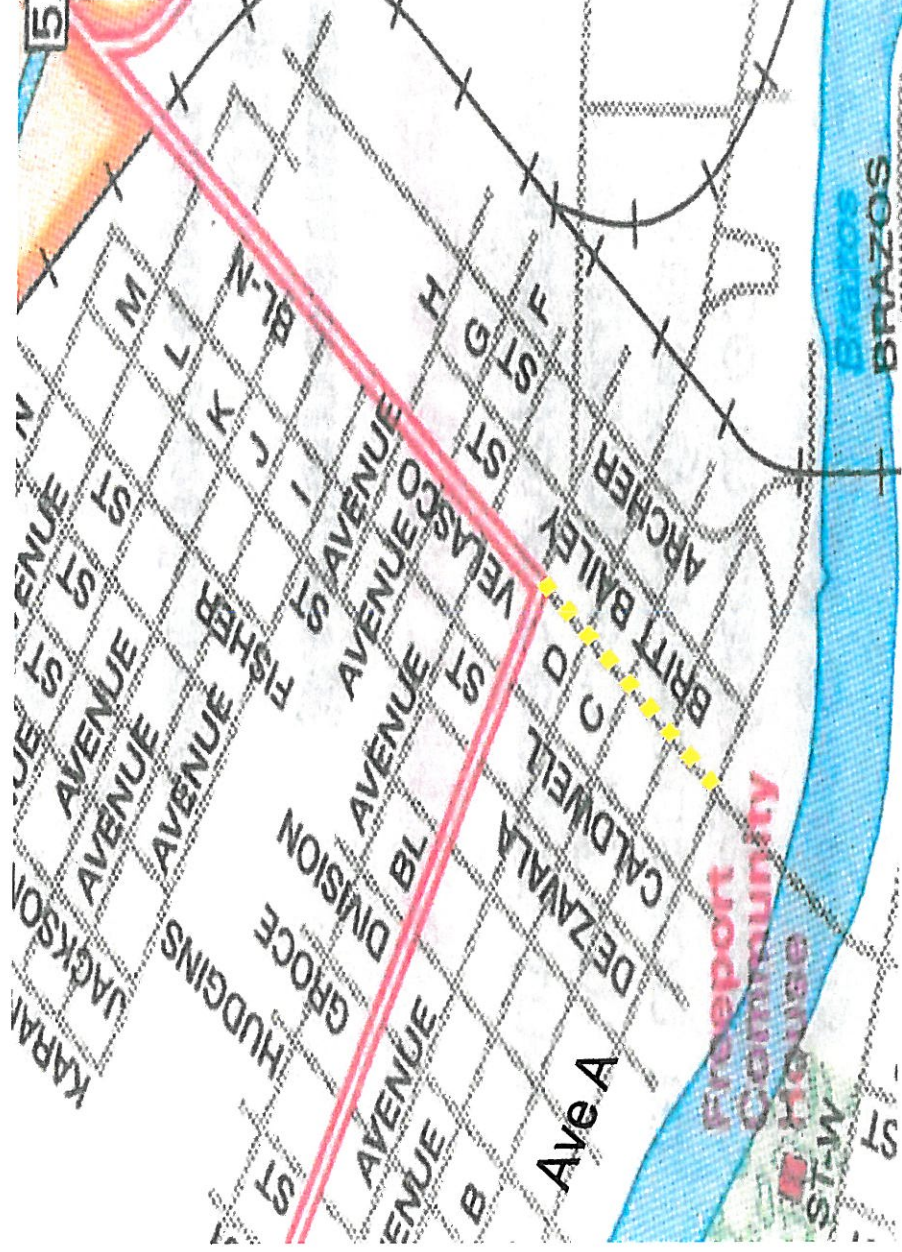

Velasco Blvd

From FM 523 junction to South Avenue A shall be open  
bi-directionally to bulk or freight travel only

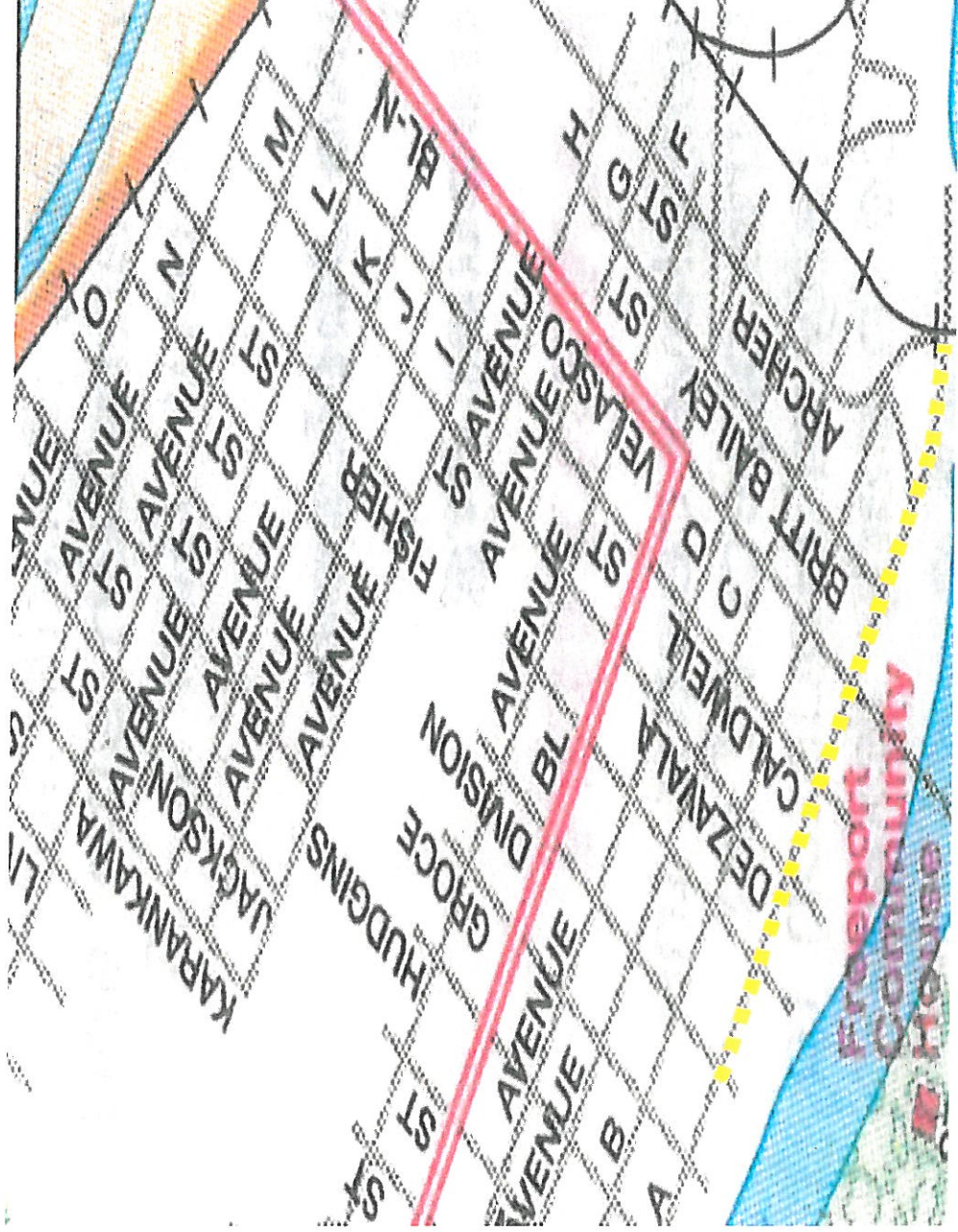

South Avenue A

From Archer to Division Street shall be open bi-directionally to bulk and freight travel only



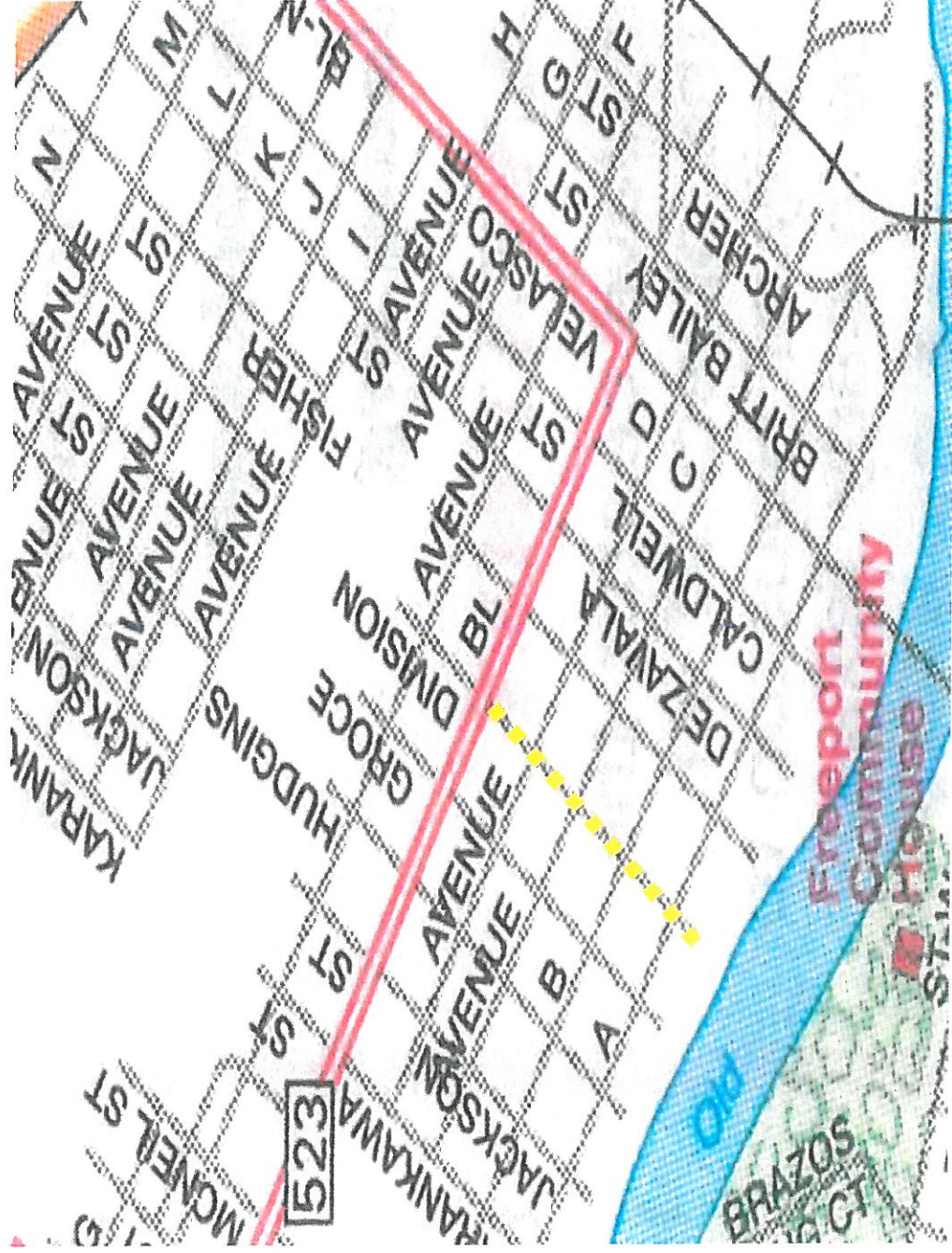

Division Street

From South Avenue A to Gulf Blvd shall be open bi-directionally for bulk or freight traffic only



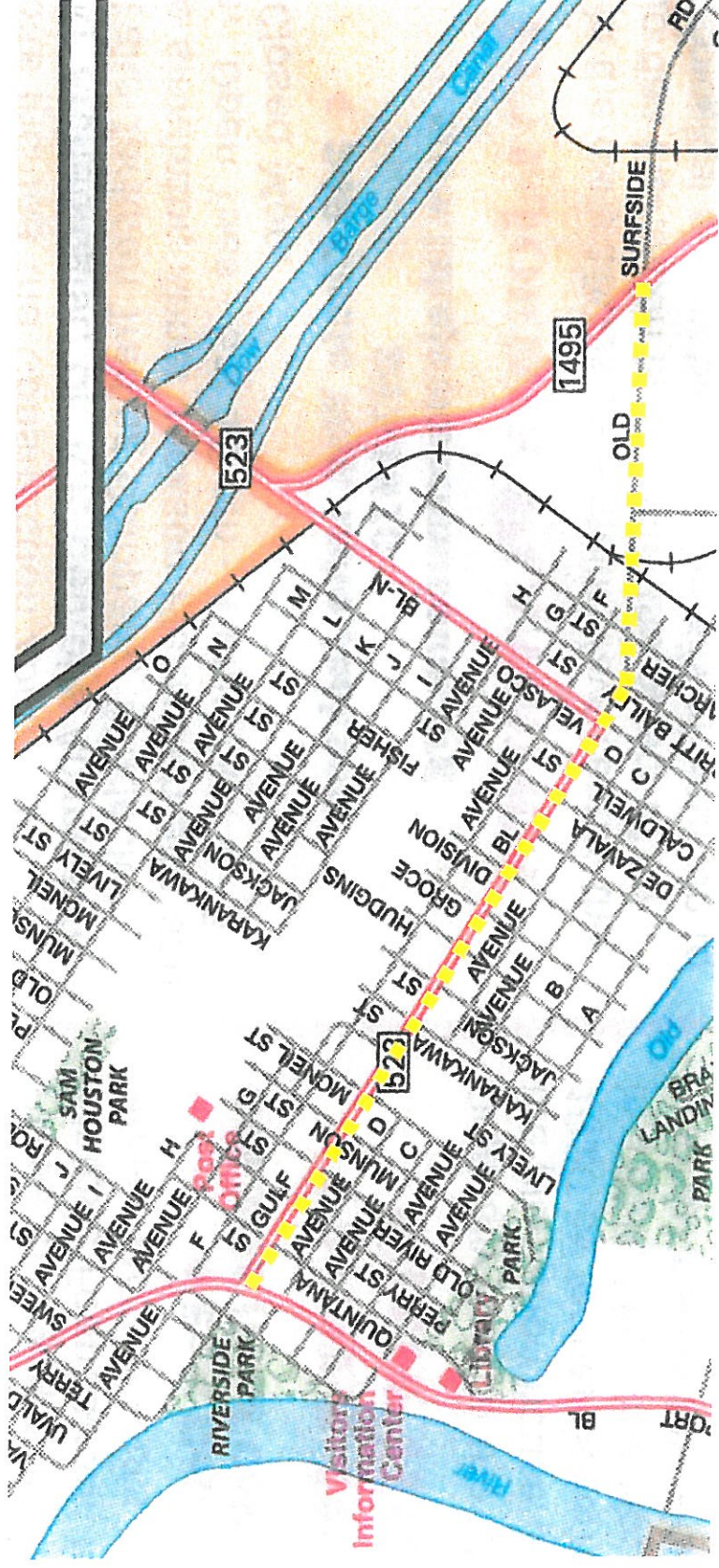

## Gulf Blvd

From Brazosport Blvd to FM 1495 shall be open bi-directionally to tractor trailer, bulk and hazardous materials



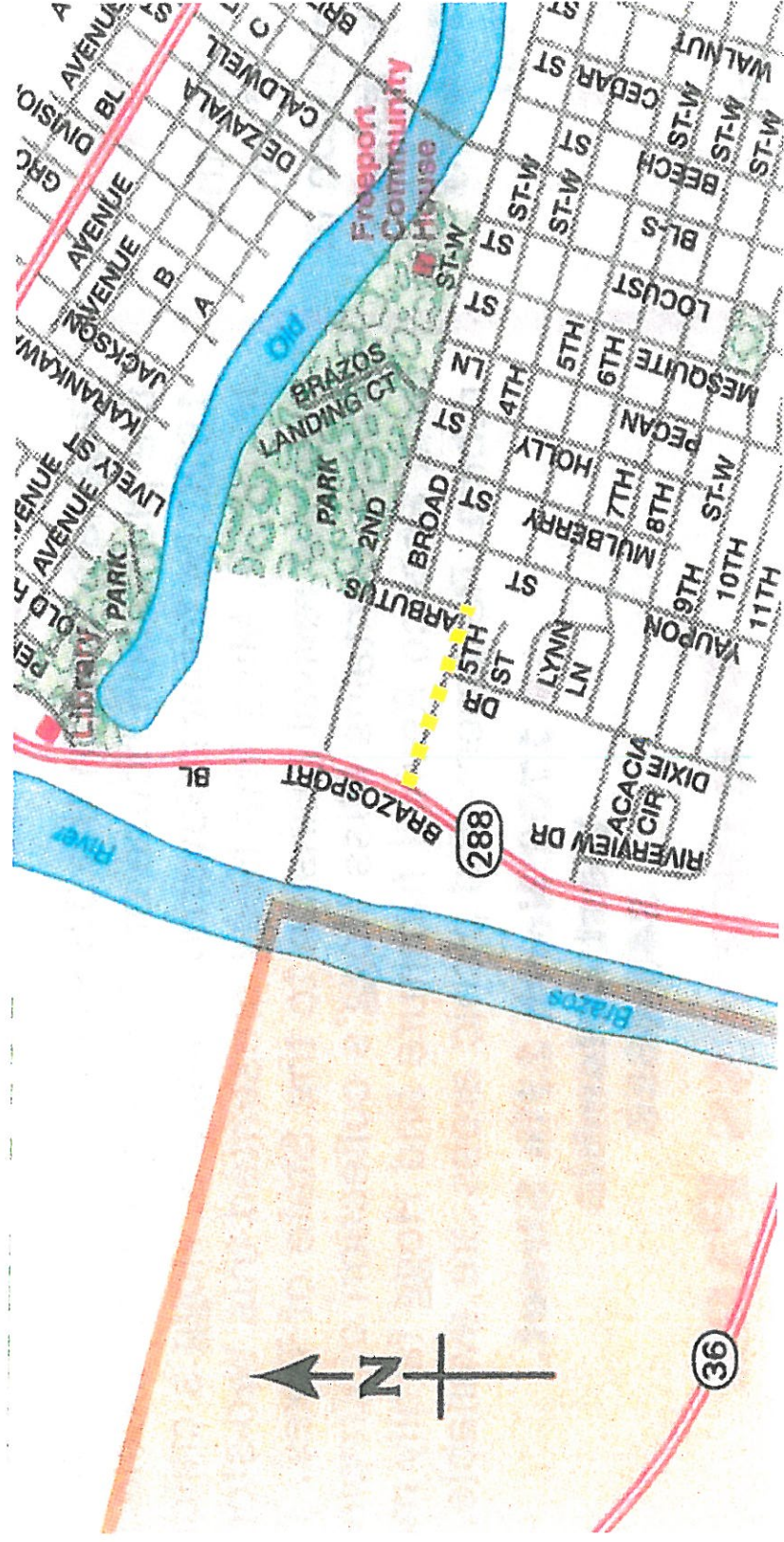

### West 4<sup>th</sup> Street

From Brazosport Blvd to Arbutus Street shall be open bi-directionally to bulk or freight traffic only



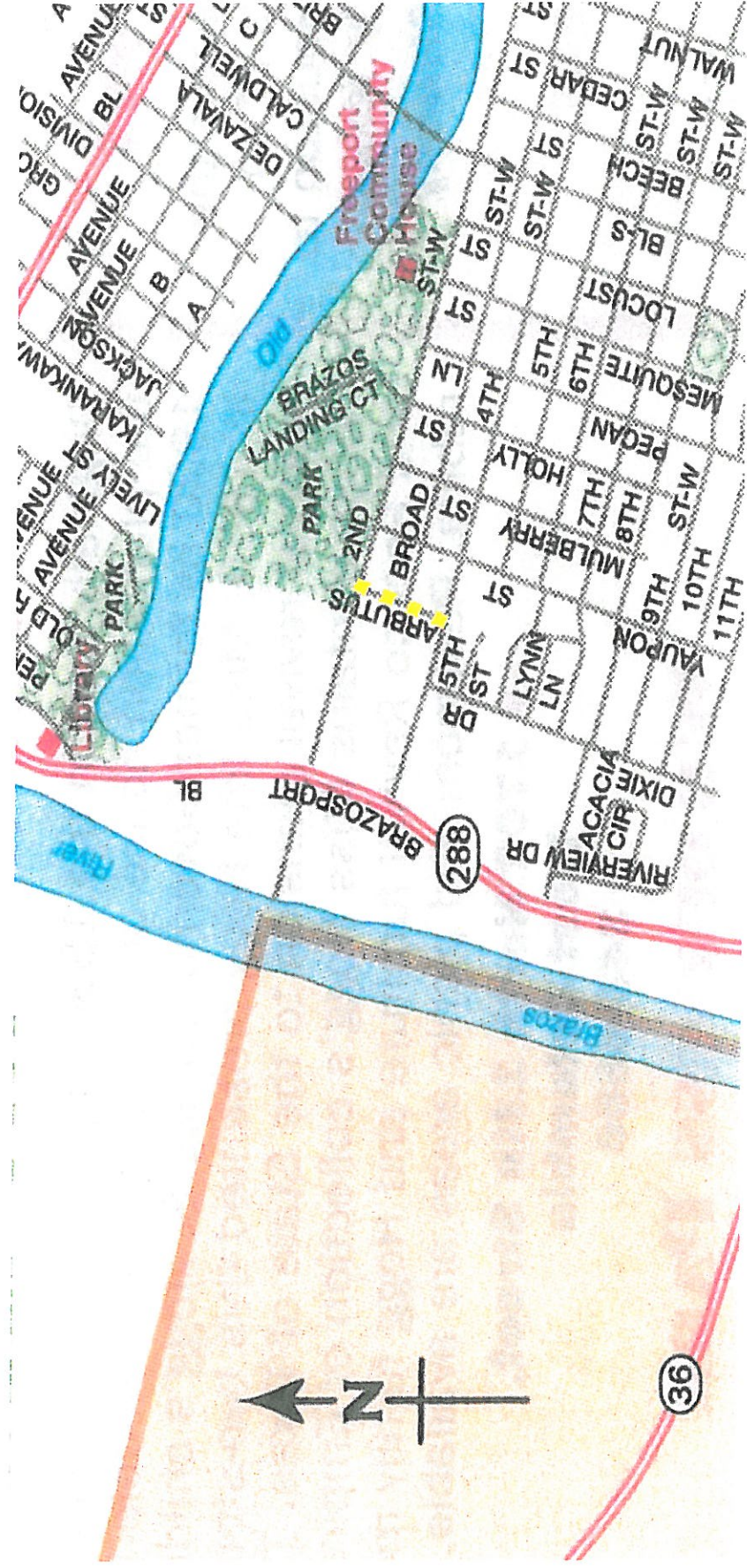

### Arbutus Street

From West 4<sup>th</sup> Street to West 2<sup>nd</sup> Street shall be open  
bi-directionally to bulk and freight traffic only



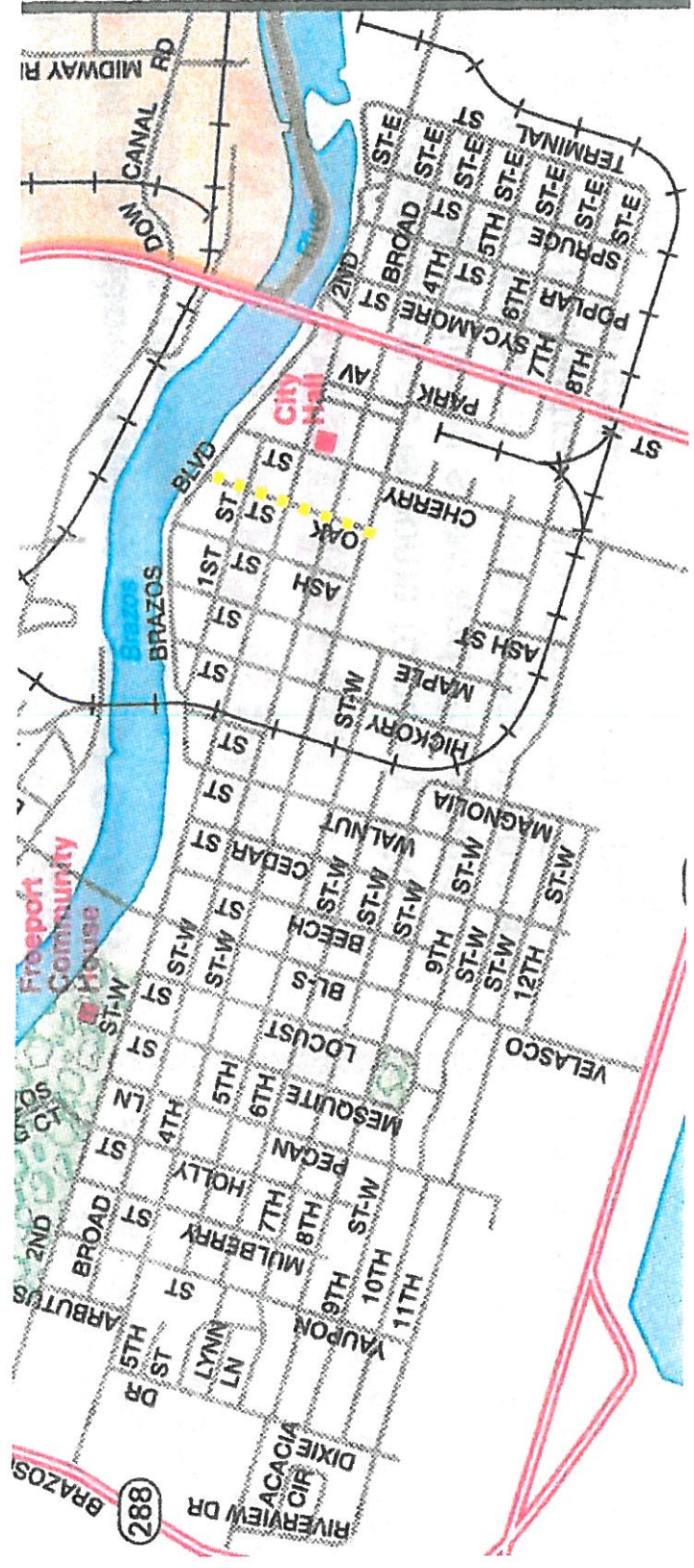

### Oak Street

From West Brazos to West 4<sup>th</sup> Street shall be open bi-directionally to bulk and freight traffic only

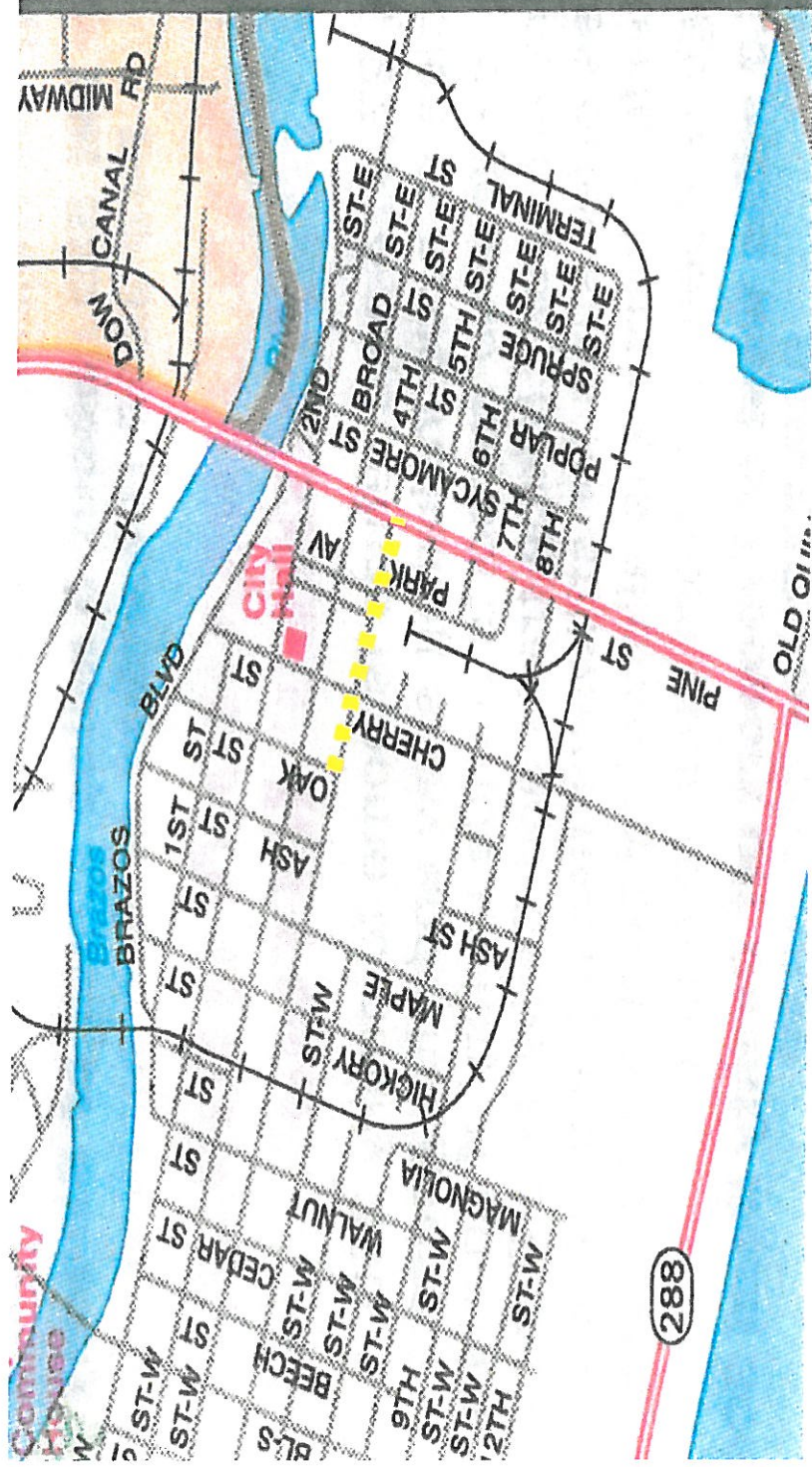

### West 4<sup>th</sup> Street

From Oak Street to FM 1495 shall be open bi-directionally for  
bulk and freight traffic only



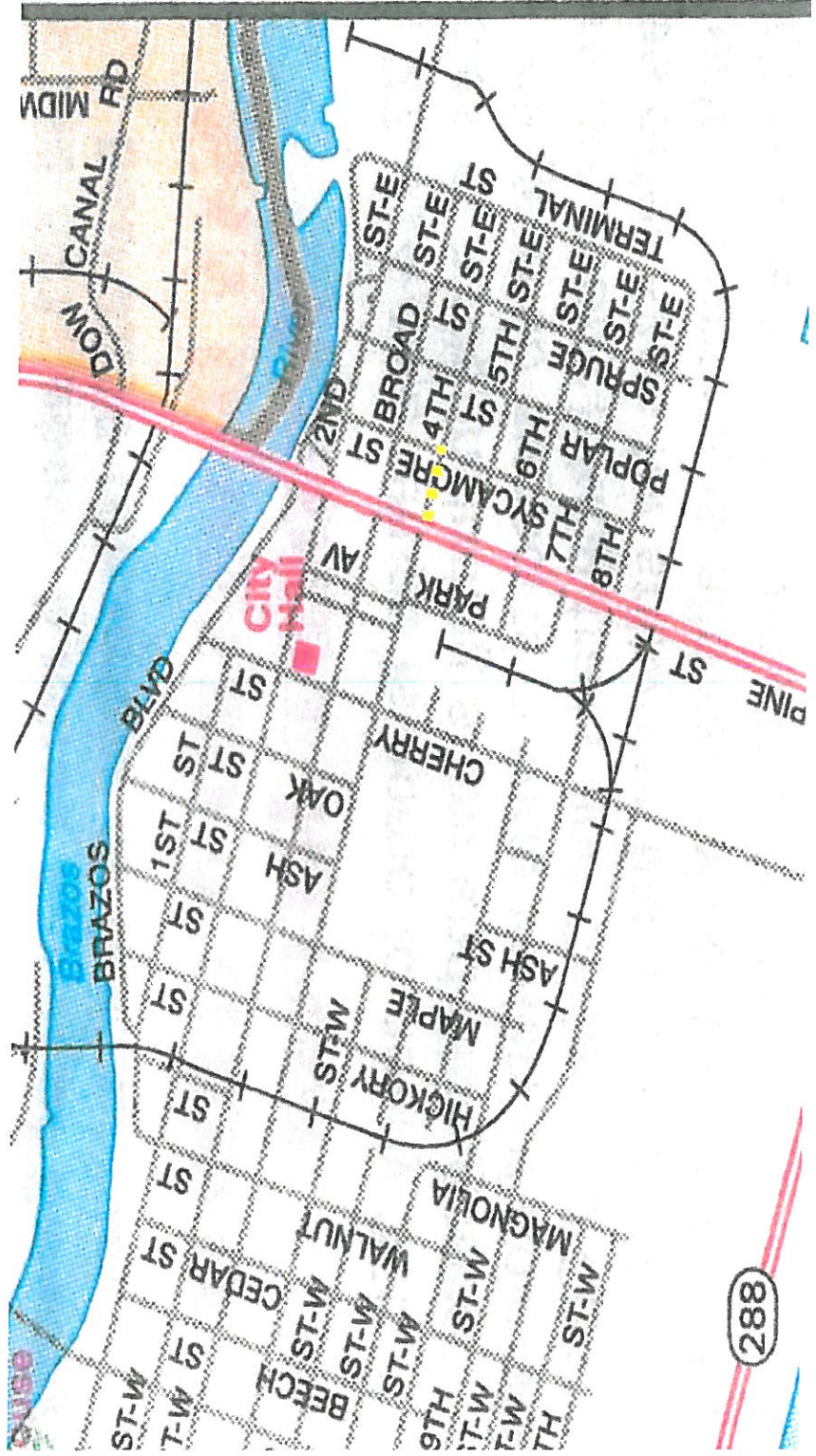

### East 4<sup>th</sup> Street

From FM 1495 to Sycamore shall be open bi-directionally to bulk, freight and hazardous materials

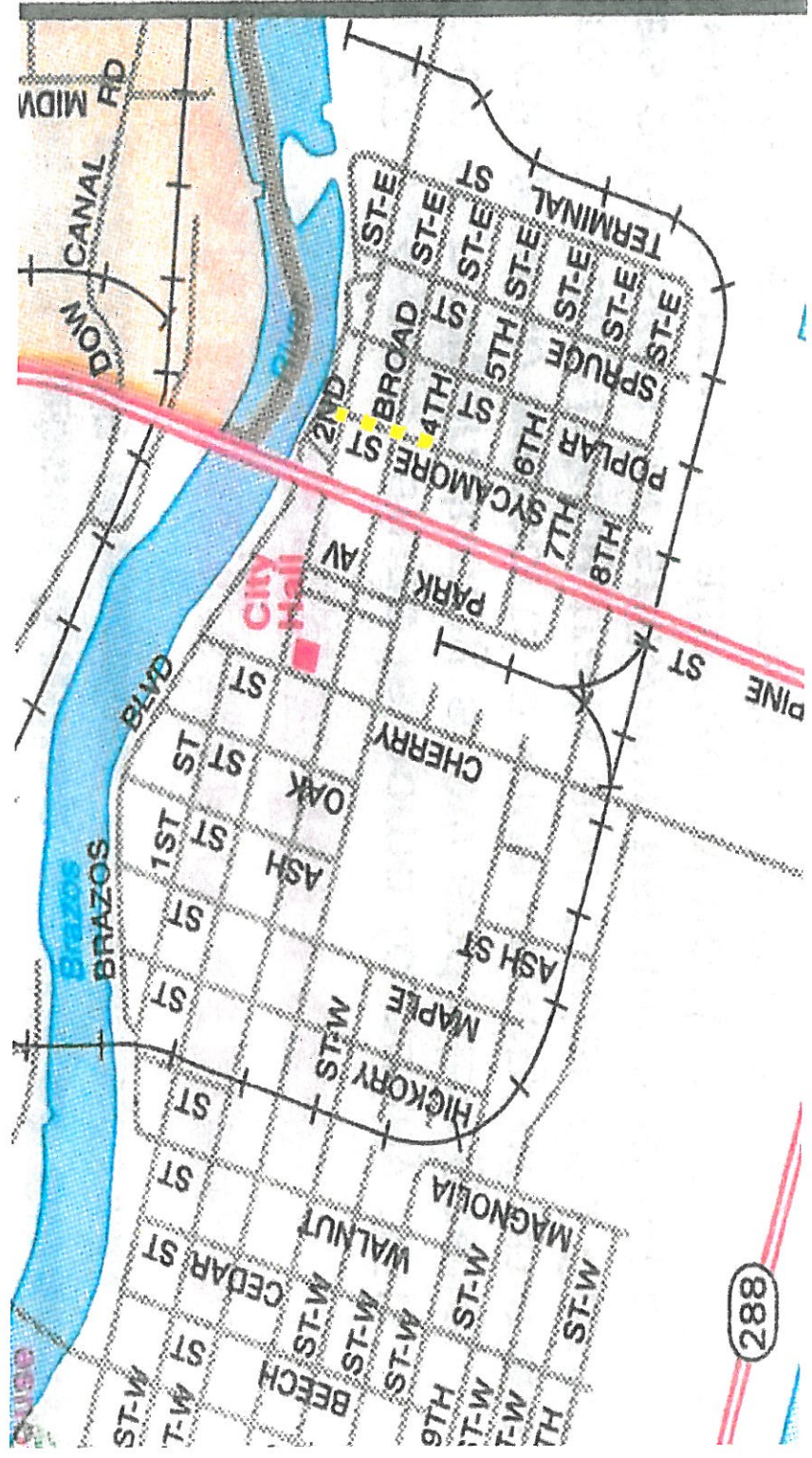

### Sycamore Street

From East 4<sup>th</sup> Street to East 2<sup>nd</sup> Street shall be open bi-directionally to bulk, freight and hazardous materials



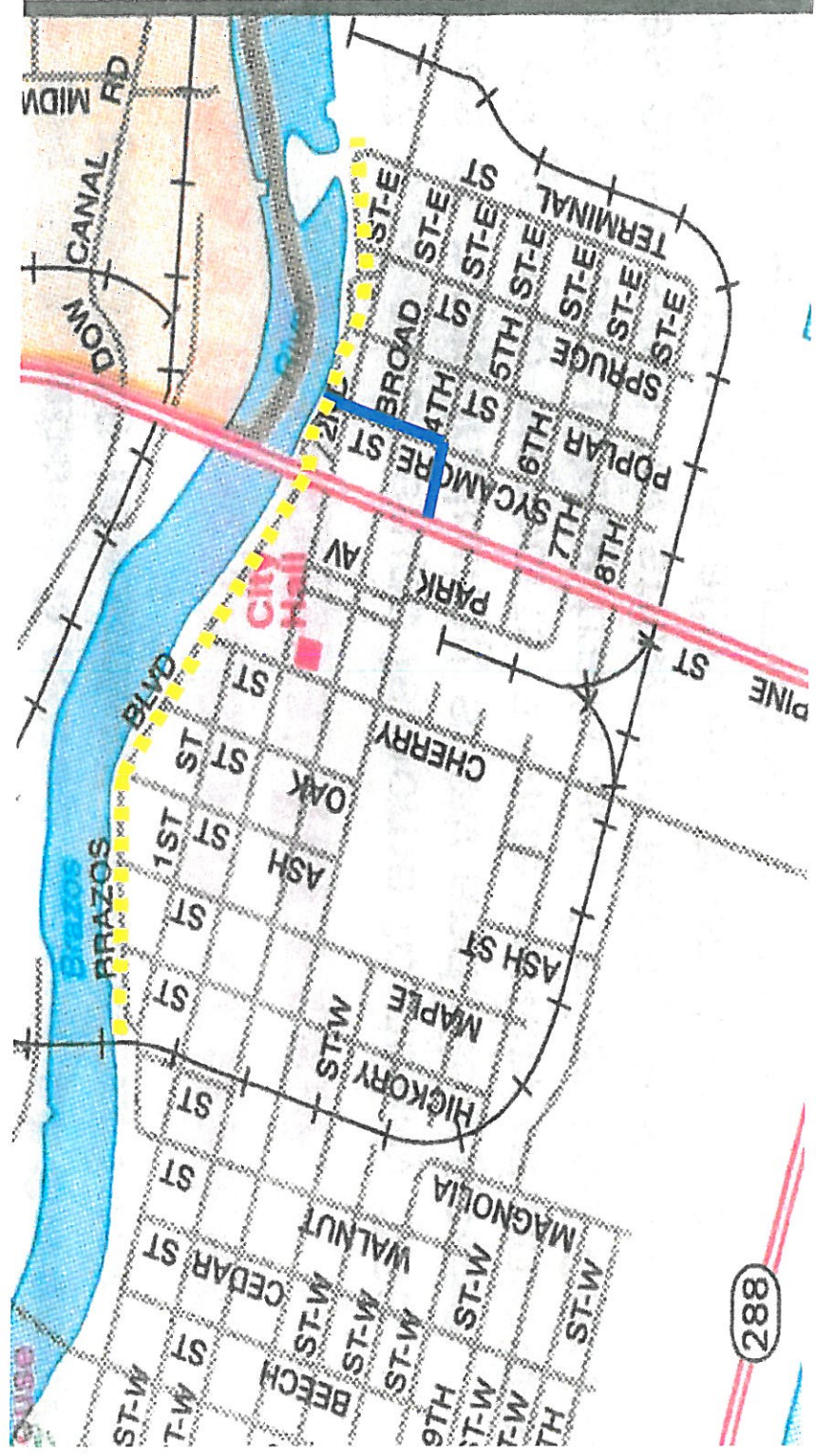

### West Brazos

Shall be open bi-directionally for bulk, freight and hazardous materials traffic. ALL ingress and egress fuel deliveries to the West Brazos area shall use the East 4<sup>th</sup> Street exit from FM 1495 to Sycamore Street to West Brazos

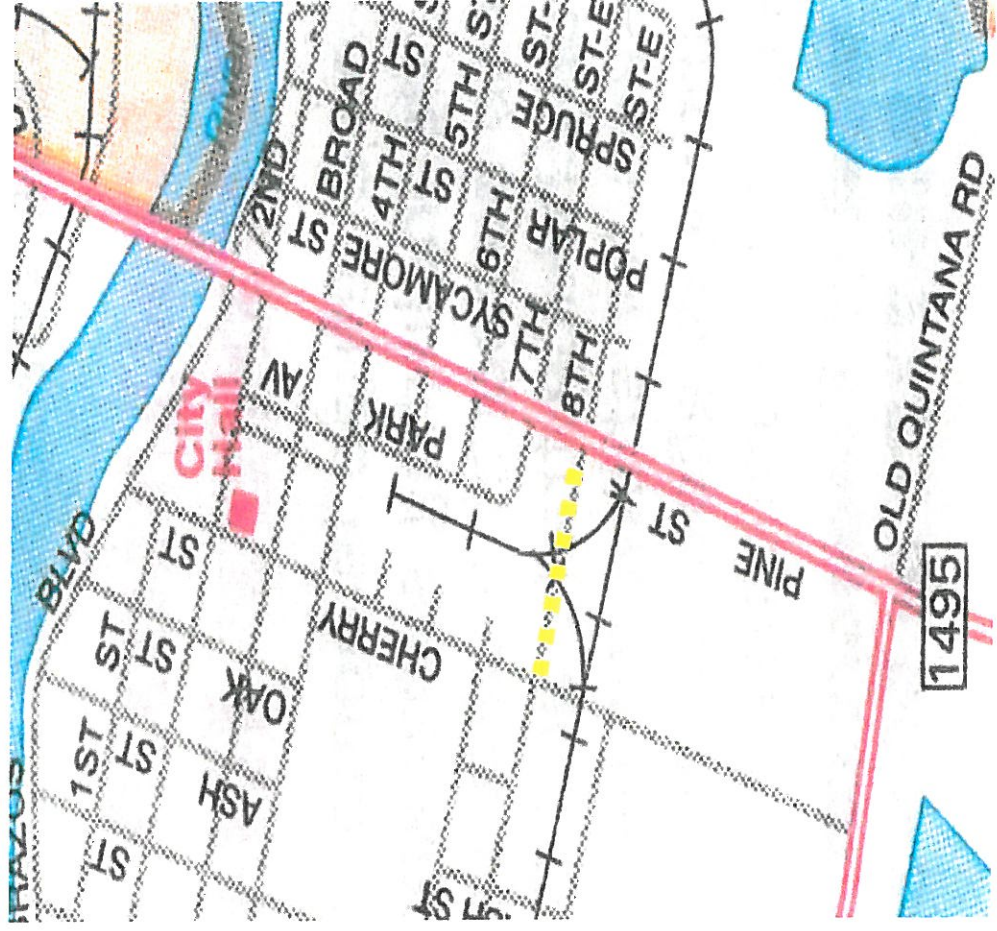

## West 8<sup>th</sup> Street

From FM 1495 to Cherry  
Street shall be open bi-  
directionally for bulk and  
freight traffic only



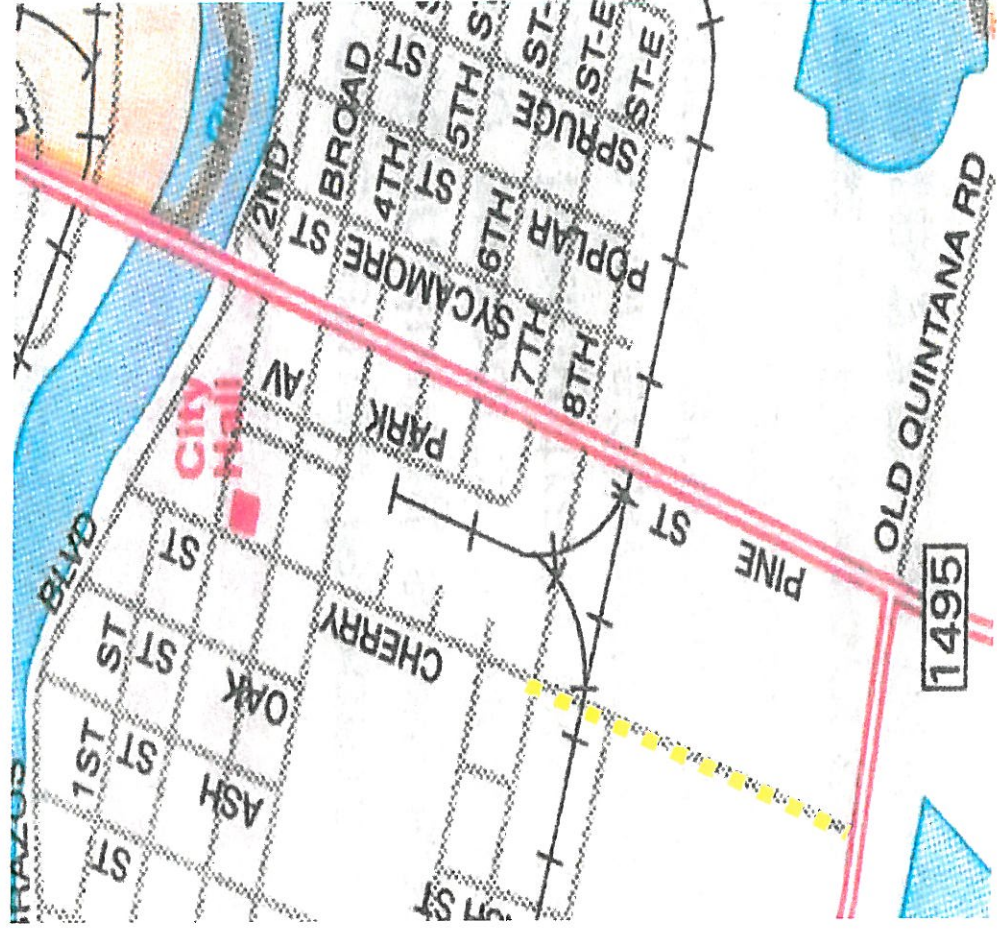

## Cherry Street

From West 8<sup>th</sup> Street to Hwy  
36 shall be open bi-  
directionally for bulk and  
freight traffic only

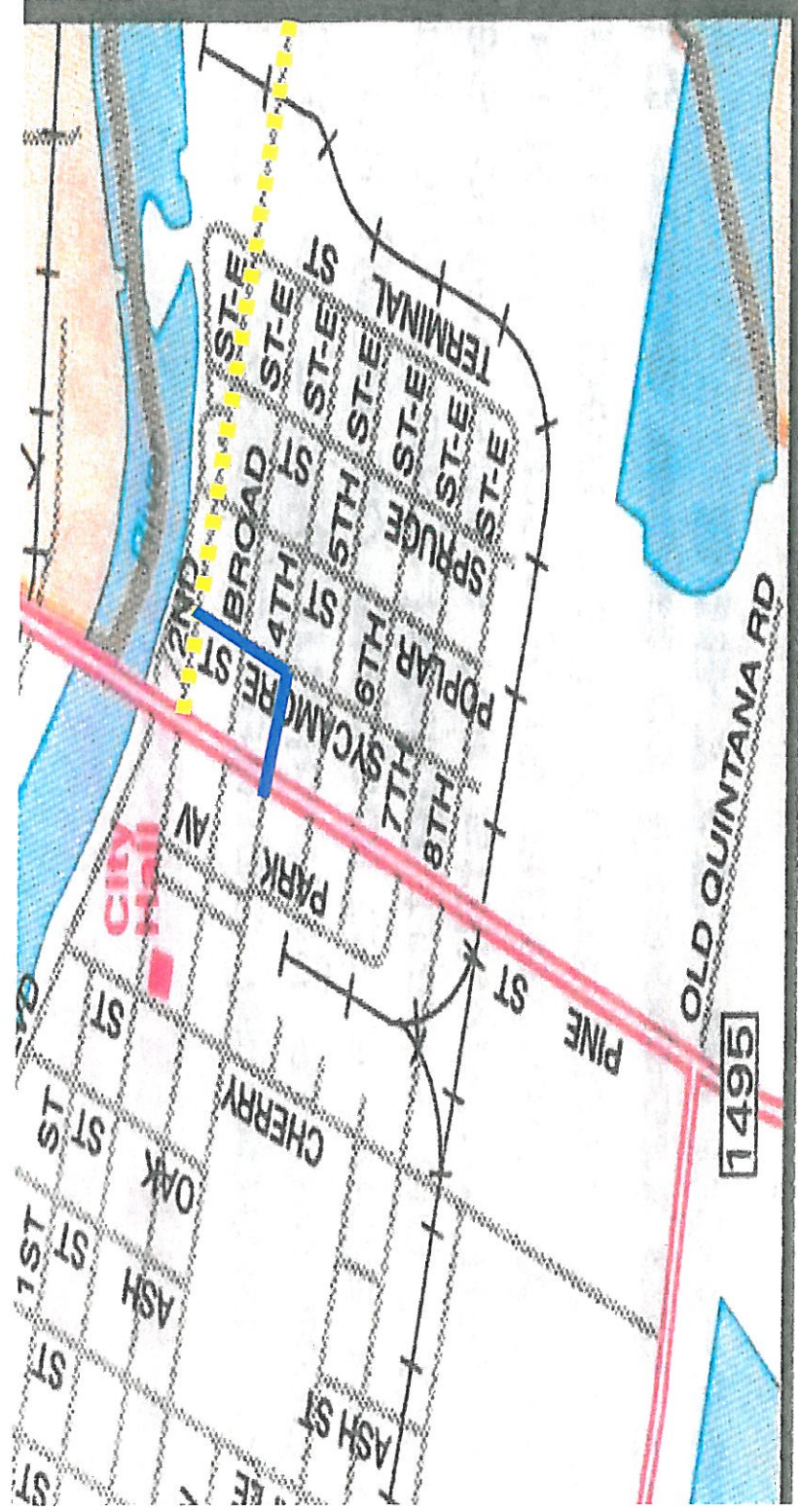

### East 2<sup>nd</sup> Street

From FM 1495 to end of roadway shall be open bi-directionally for bulk, freight and hazardous materials traffic. ALL hazardous materials deliveries shall ingress and egress using the East 4<sup>th</sup> Street exit from FM 1495 to Sycamore Street to East 2<sup>nd</sup> Street



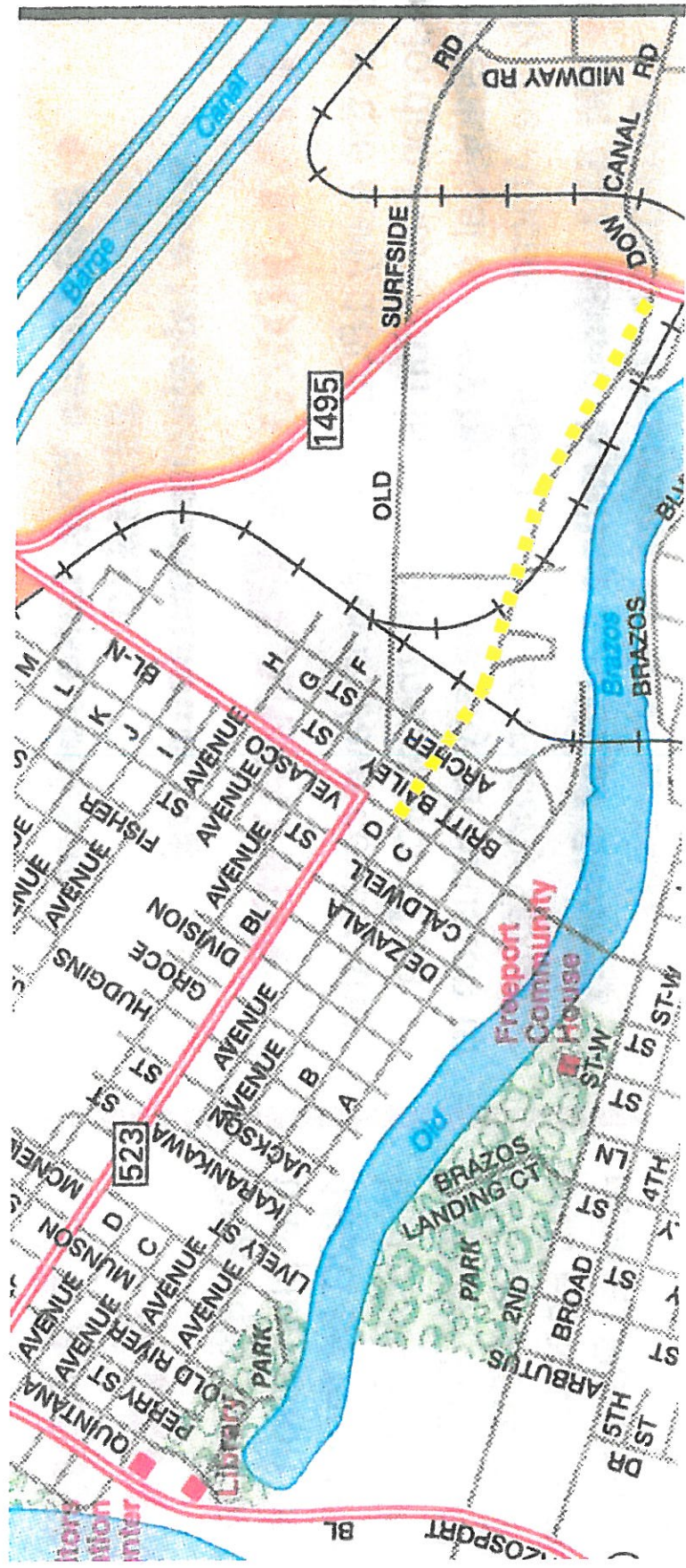

### South Avenue D

From Velasco Blvd to FM 1495 shall be open bi-directionally for bulk and freight traffic only

Pete Shaffe Blvd

From FM 1495 to Port Road shall be open bi-directionally for bulk and freight traffic as well as Port of Freeport controlled hazardous materials



## Port Road

From Pete Shaffe Blvd to end of roadway shall be open bi-directionally for bulk and freight traffic as well as Port of Freeport controlled hazardous materials

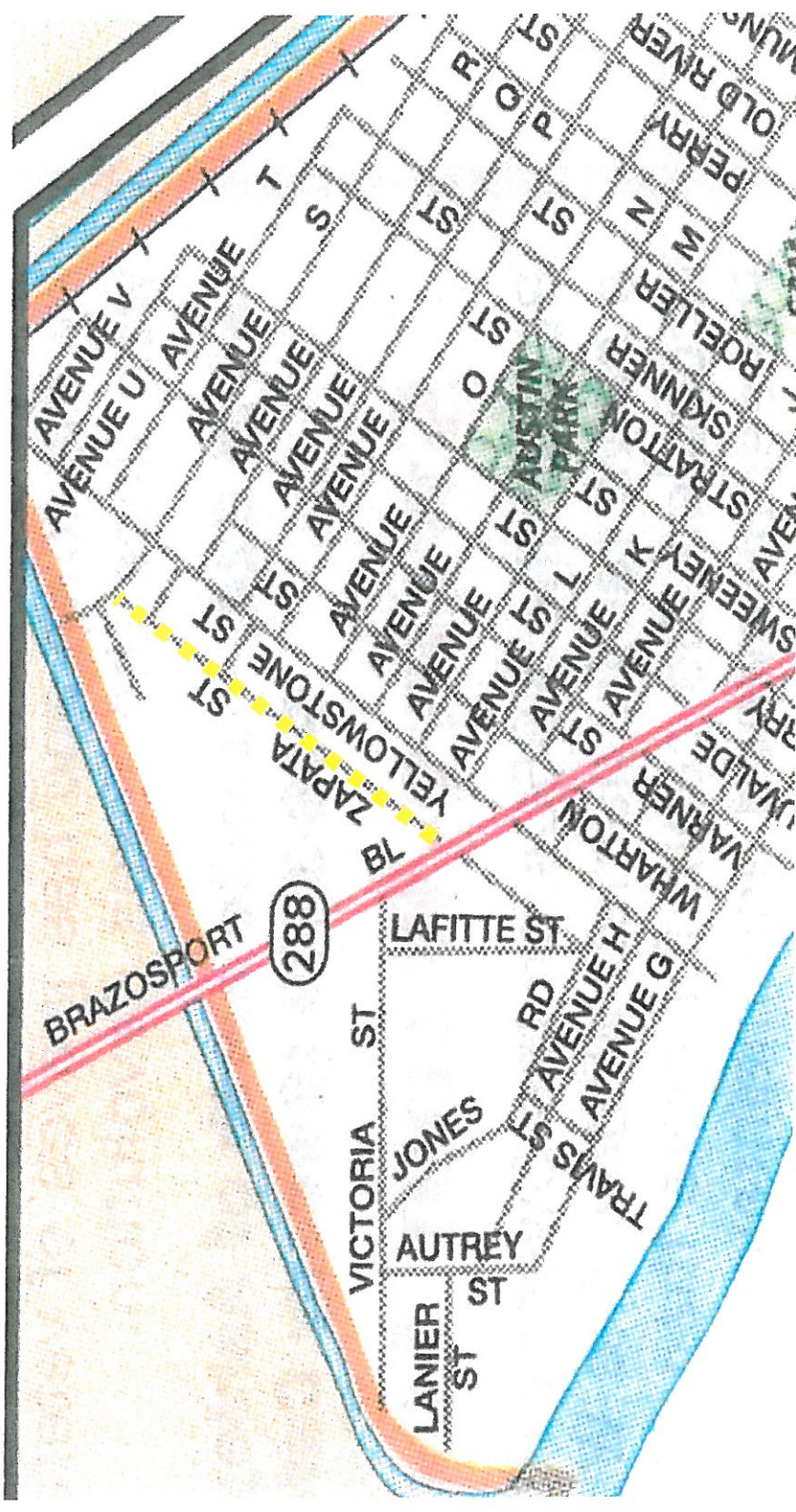

Zapata Street

From Brazosport Blvd to end of roadway shall be open bi-directionally for bulk and freight traffic only



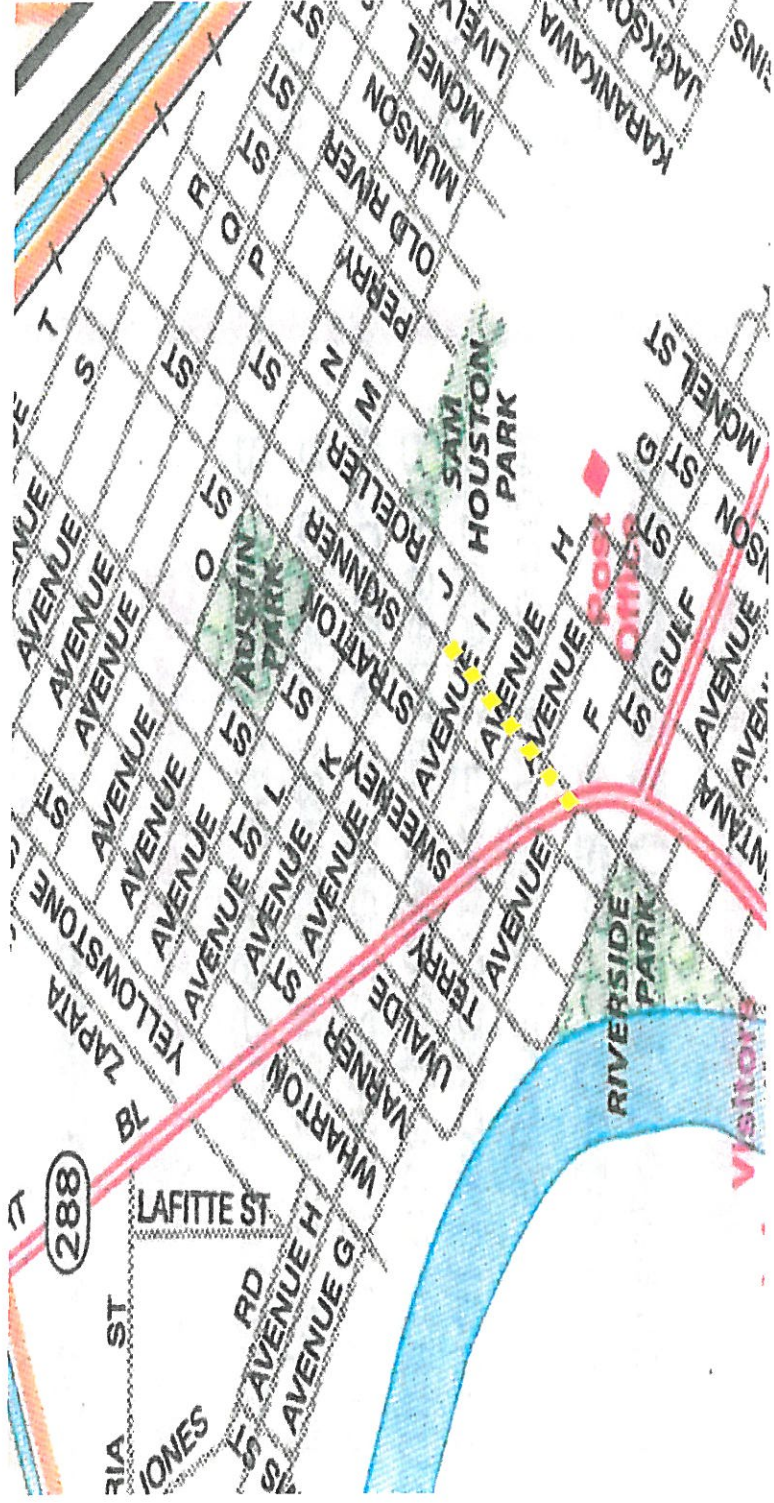

### Skinner Street

From Brazosport Blvd to North Avenue J shall be open  
bi-directionally to bulk and freight traffic only

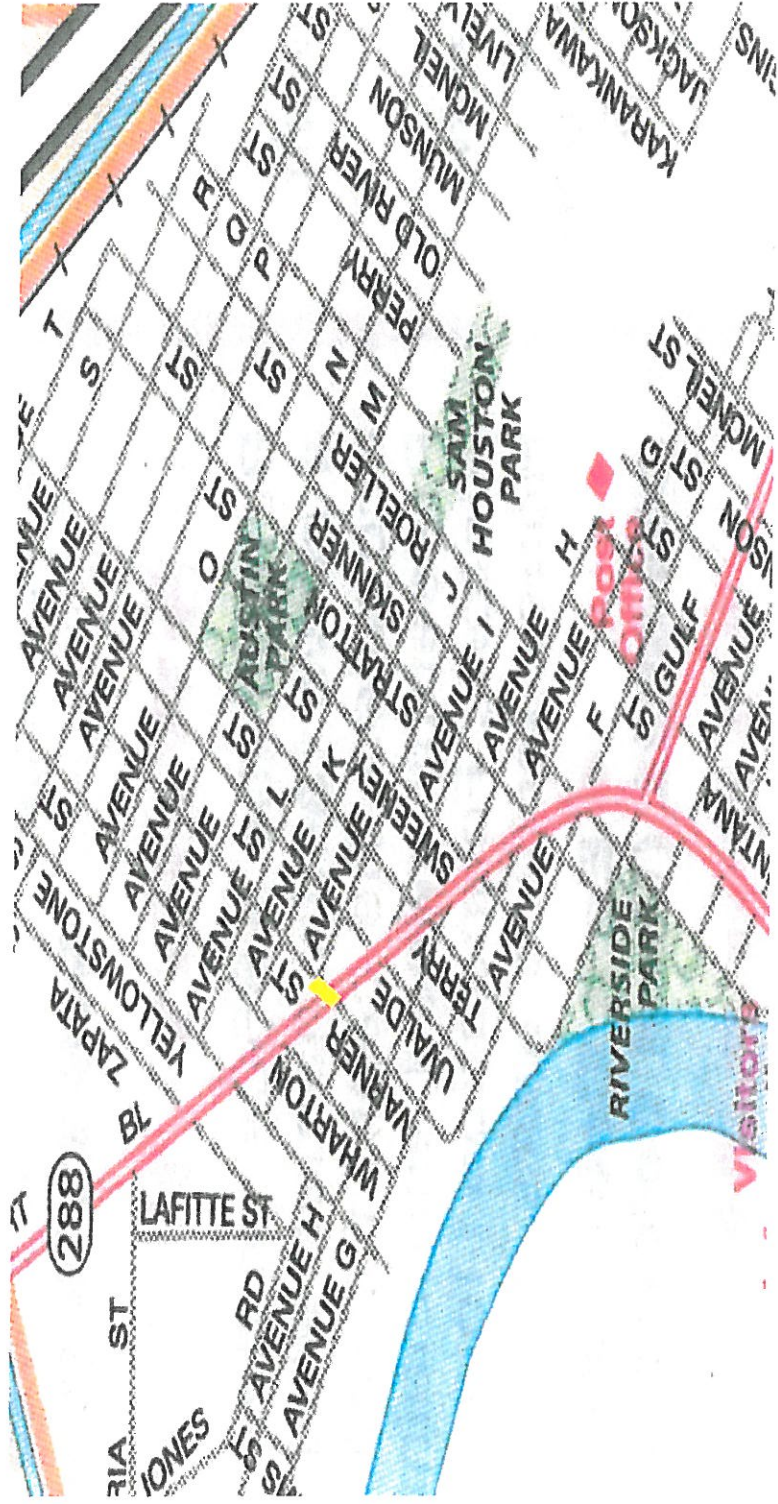

### Varner Street

From North Avenue J to Brazosport Blvd shall be open  
bi-directionally to bulk and freight traffic only



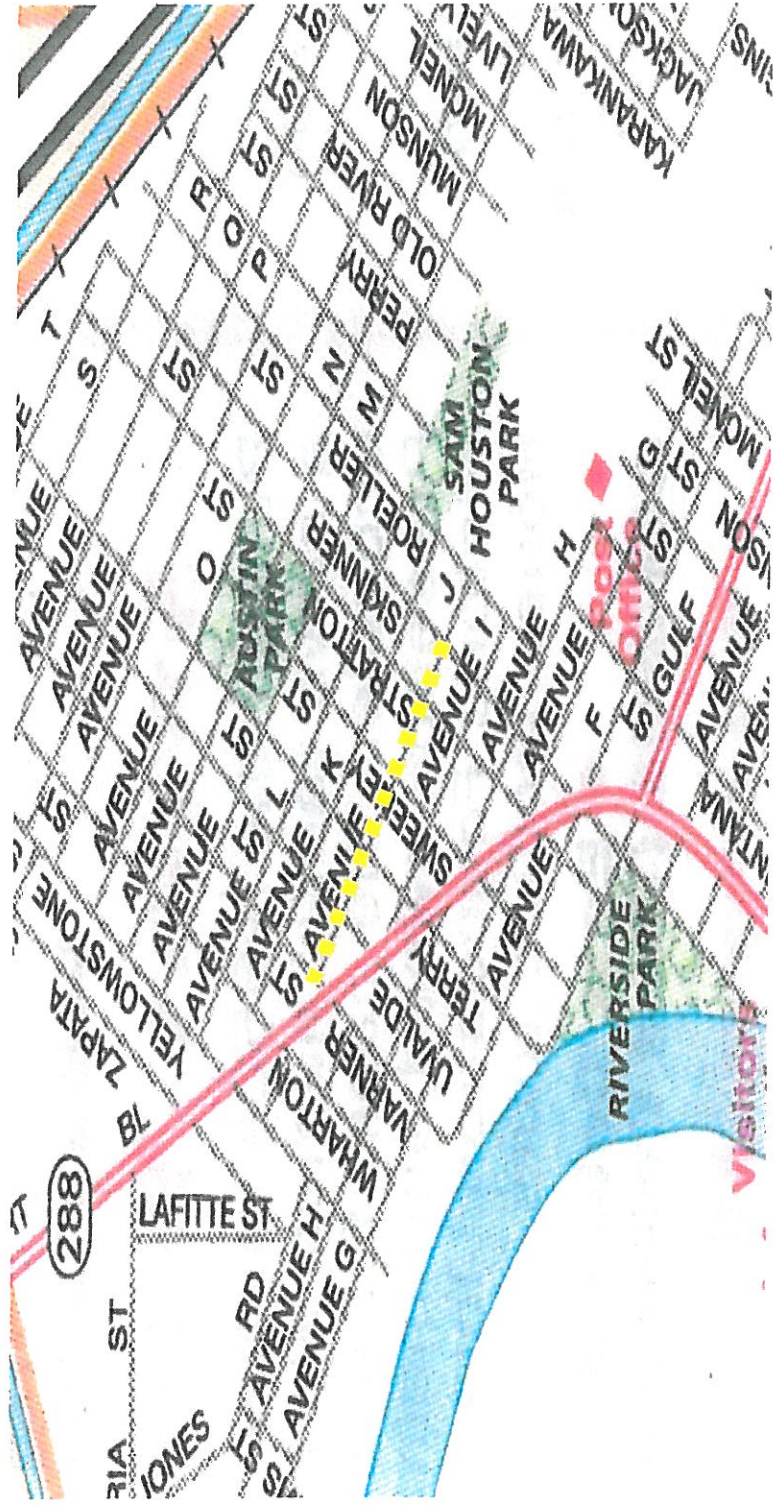

### North Avenue J

From Skinner Street to Varner Street shall be open bi-directionally to bulk and freight traffic only



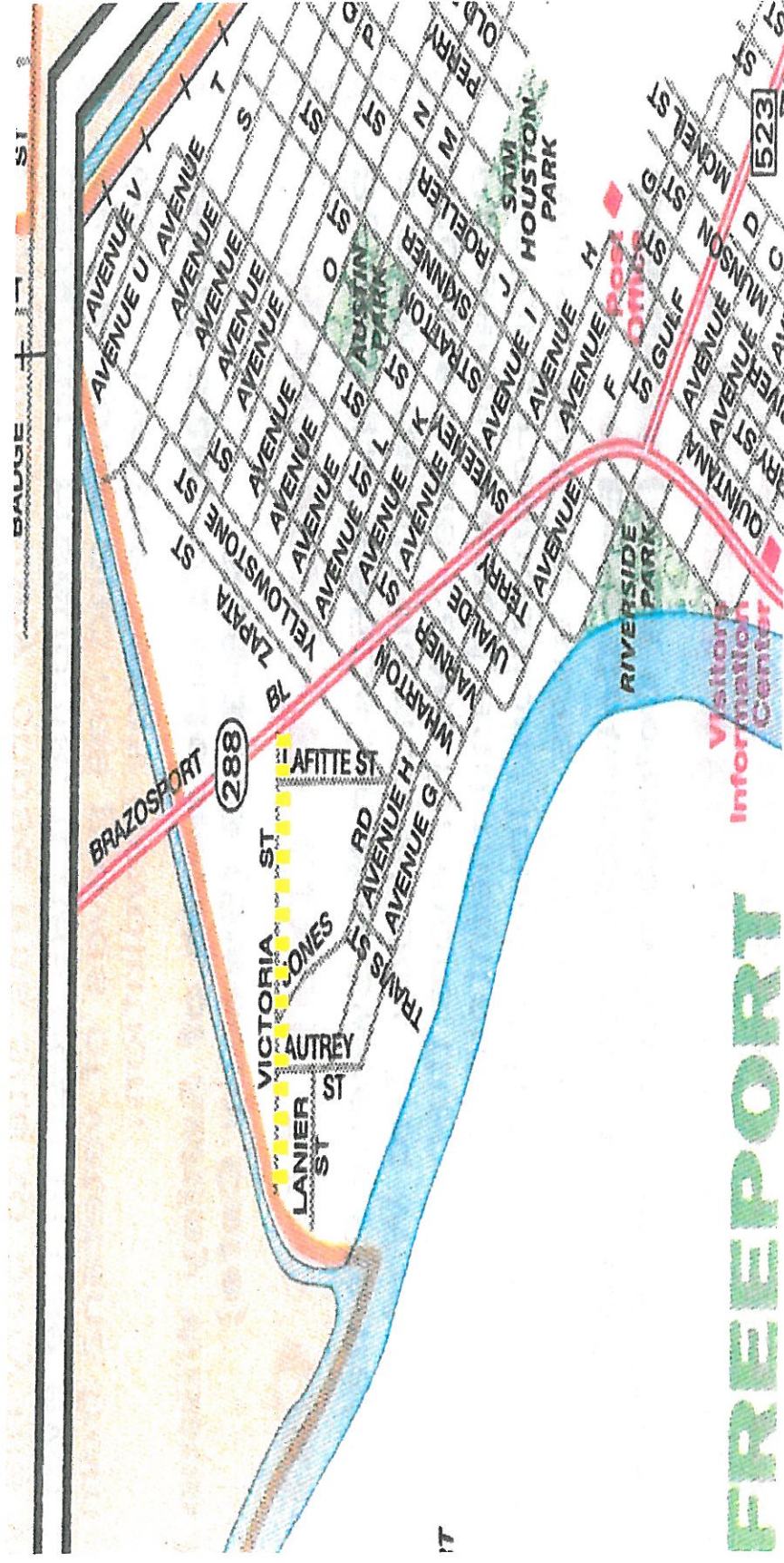

### Victoria Street

From Brazosport Blvd to end of roadway shall be open for bulk, freight and hazardous materials



Archer Street

From South Avenue A to South Gulf Blvd shall be open for bulk and freight traffic only



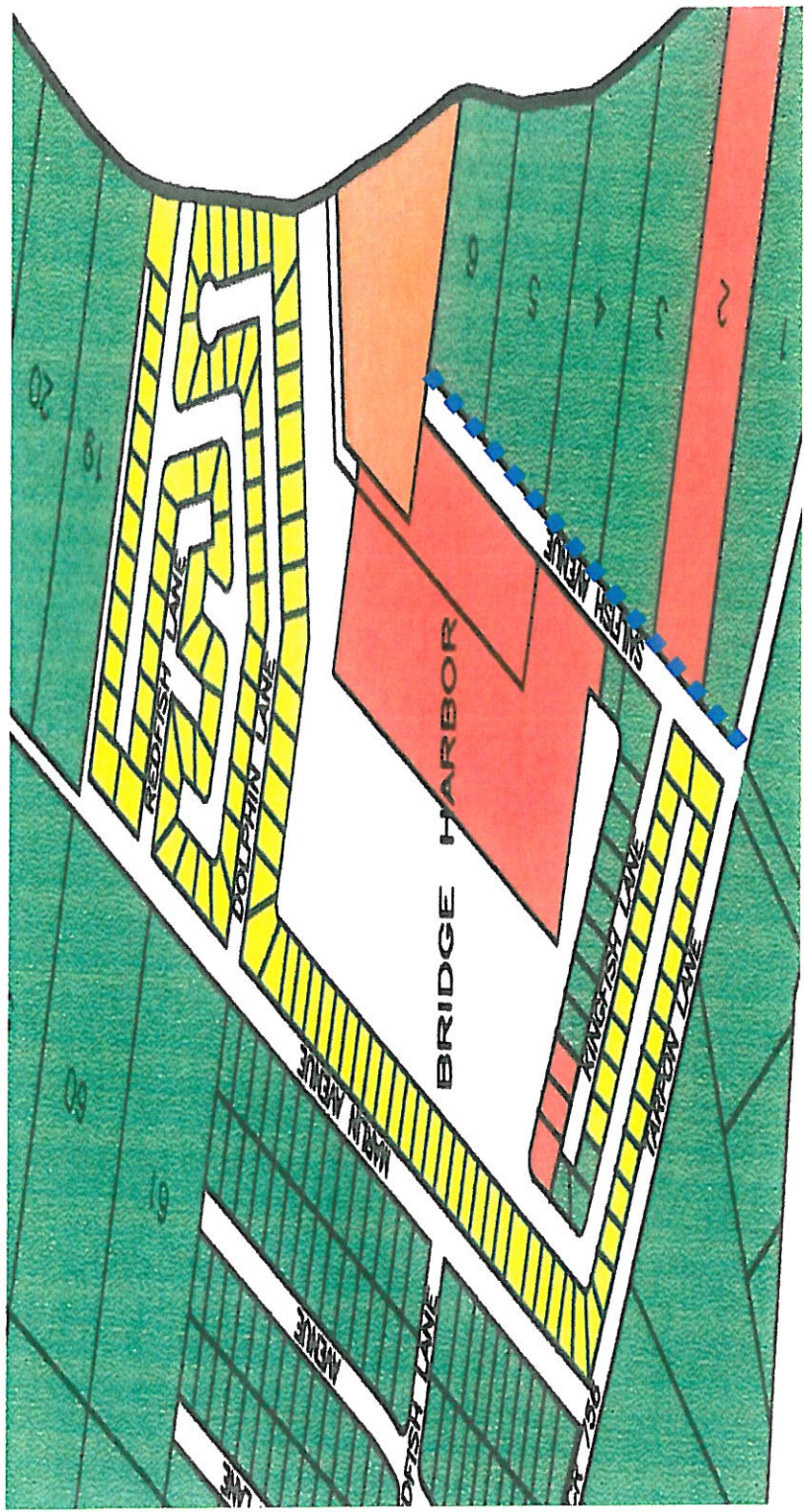

## Sailfish

From Hwy 332 to end of roadway shall be open  
bi-directionally to bulk and freight traffic only



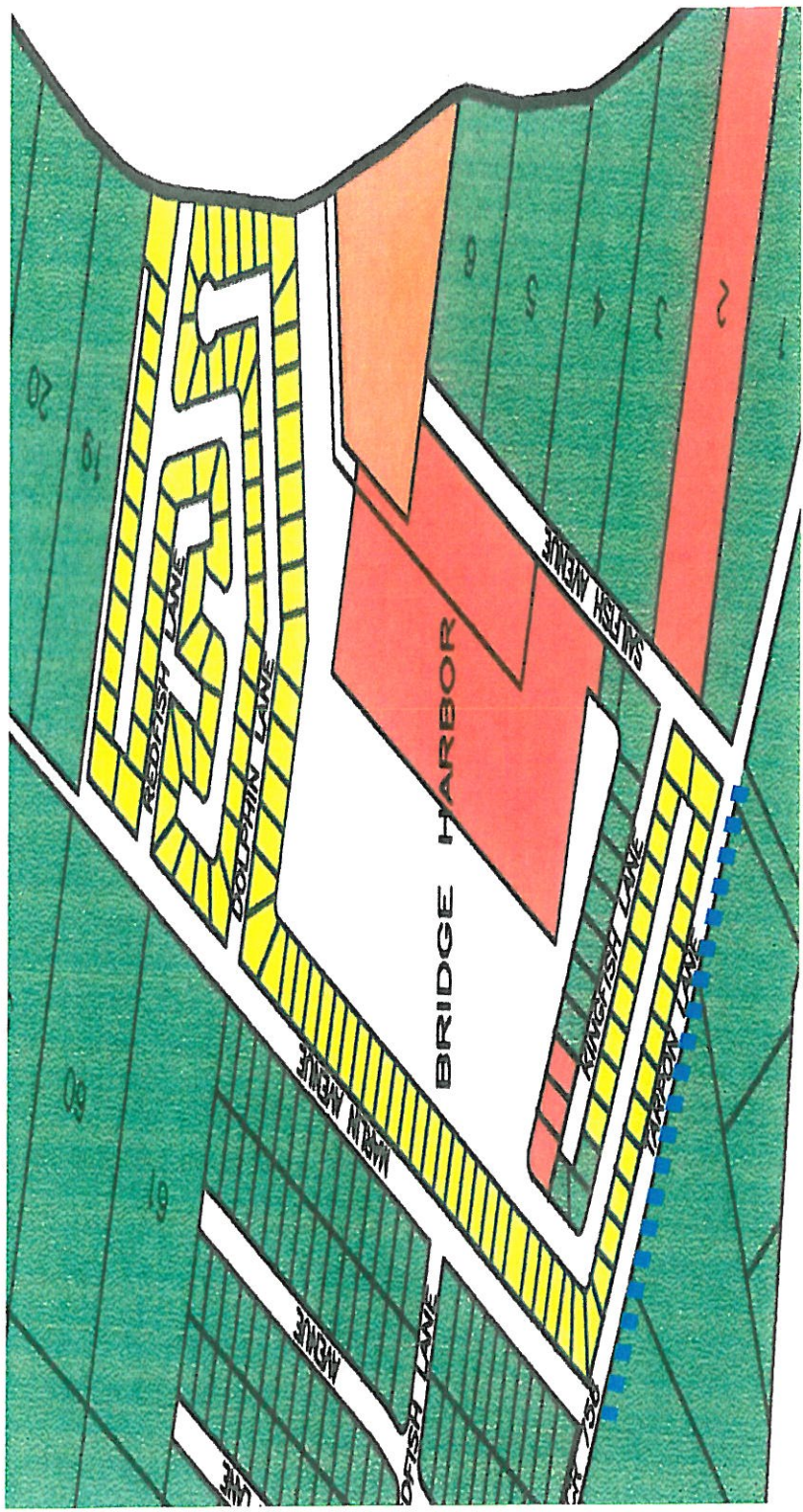

## Tarpon

From Sailfish to Marlin Avenue shall be open bi-directionally  
for bulk and freight traffic only



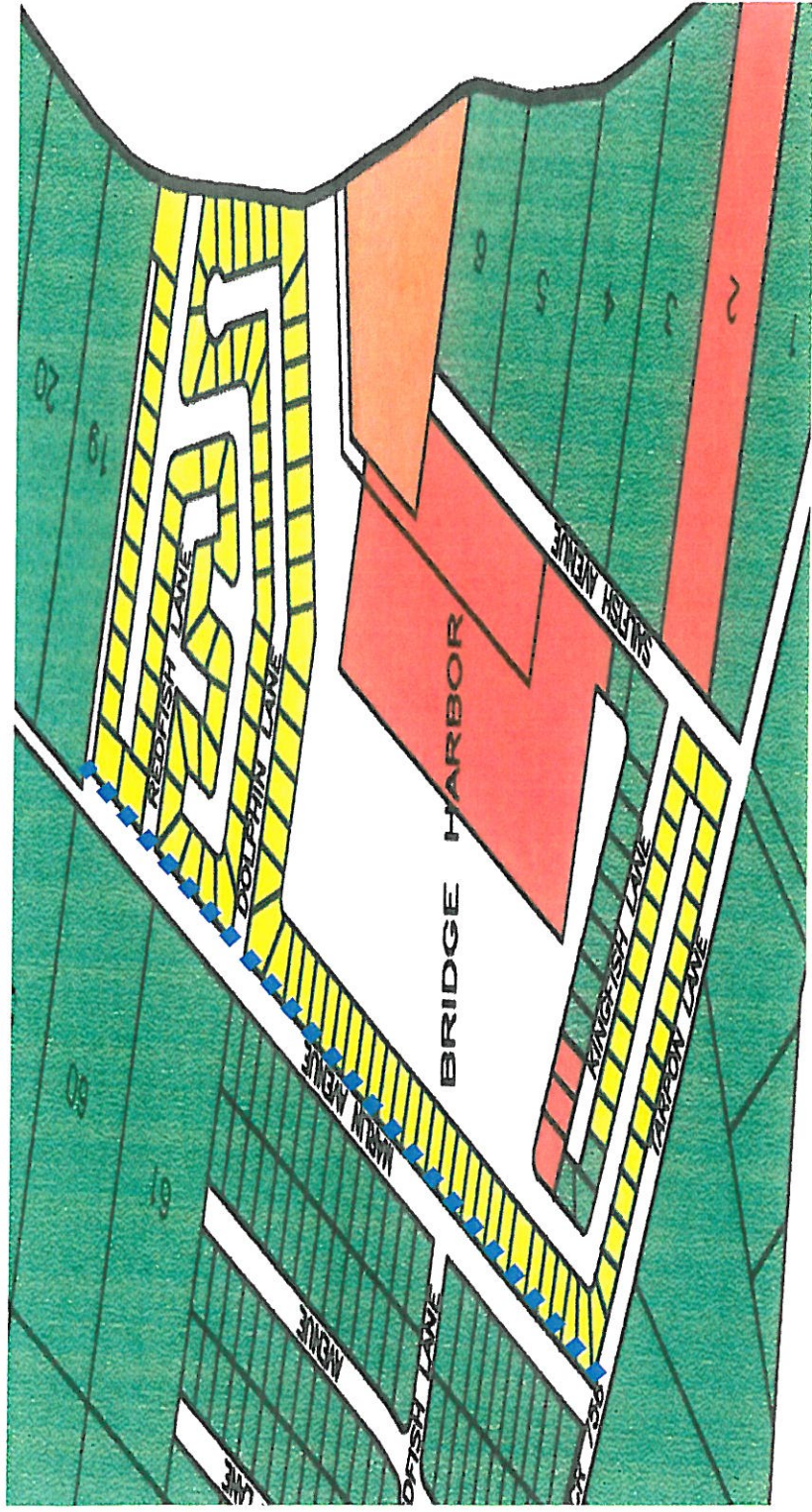

### Marlin Avenue

From Tarpon to the end of the roadway shall be open bi-directionally  
for bulk and freight traffic only

Casco

From Hwy 332 to end of roadway shall be open bi-directionally for bulk and freight traffic only

---



# City of Freeport Truck Route

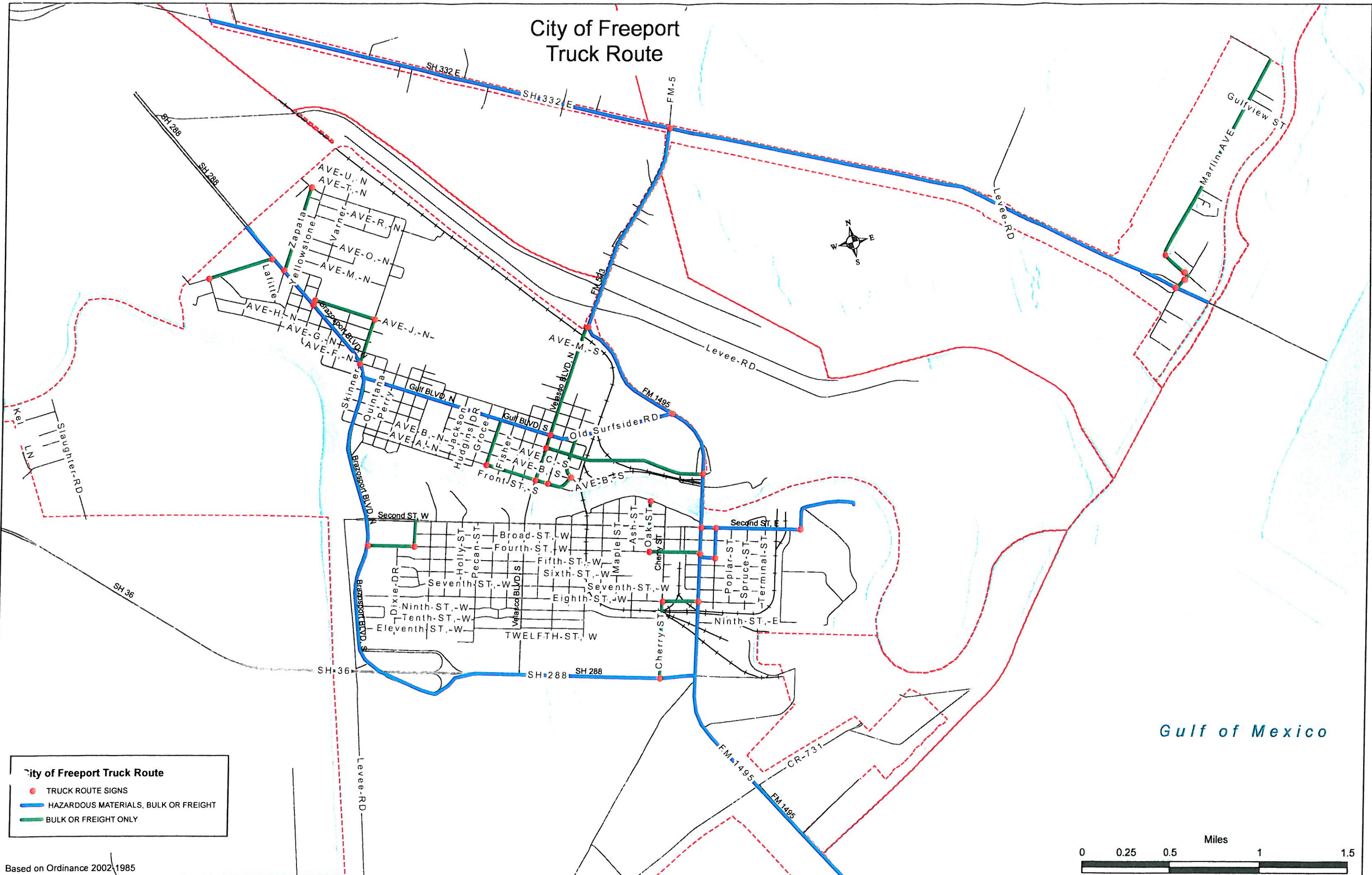

**City of Freeport Truck Route**

- TRUCK ROUTE SIGNS
- HAZARDOUS MATERIALS, BULK OR FREIGHT
- BULK OR FREIGHT ONLY

Based on Ordinance 2002-1985

